

DH.100 Vampire FB.6 'Pinocchio Nose'

EN

Development of jet fighter later to be named Vampire began in 1941 and related closely with development of H-1 jet engine, for which the engine section of de Havilland company was responsible. The engine was known later under its new name Goblin and its development was very successful. The Vampire was therefore ordered under Air Ministry specification E6/41 for an experimental machine able to be converted to fighter plane. The design of the plane was fully adjusted to the new engine, which resulted in overall tiny dimensions of the plane, very low undercarriage and the tail planes being carried by two slim tail booms. The first prototype, unofficially named Spider Crab, flew for the first time on September 20, 1943 with G. de Havilland Jr at the controls. The trials were a success and an order for first 120 planes was placed in May 1944 and was continuously increased. The production planes were licence-built by English Electric since de Havilland was busy producing Mosquitoes. The original name Spider Crab was rejected by the RAF and changed to Vampire Mk.I.

First squadrons got their Vampires in May 1945, but did not take part in the war. The development continued in further versions, besides the versions with DH Goblin engine, there were also versions with Nene engine (built in Australia), two-seat night fighter versions, two-seater training versions or naval fighter versions. The most widespread versions were the Mk.3 with more powerful Goblin and re-designed tail planes and FB.5 with shorter wingspan and adapted for carrying out ground attack sorties. Export versions were derived from the latter as well as tropicalised FB.9. Vampires flew not only in the RAF and FAA, but also in many countries of all continents except for Antarctica. Complete list of all countries where this plane flew would be rather long. In some of them the Vampires were also licence-built.

Performance

Wingspan: 12.19 m, length: 9.37 m, max. speed: 855 km/h, range: 1,960 km, service ceiling: 13,045 m, rate of climb 24.4 m/sec, armament: 4x 20mm cannon, rockets or bombs up to 500kg.

CZ

Vývoj proudové stíhačky, nesoucí později bojové jméno Vampire, byl zahájen již v roce 1941. Úzce souvisel s vývojem proudového motoru H-1. Ten vyvíjelo motorářské oddělení firmy de Havilland. Vývoj motoru, pojmenovaného později Goblin byl velmi úspěšný. Proto britské ministerstvo letectví vypsalo specifikace E.6/41 požadující experimentální stroj, upravitelný na stíhací. Konstrukce letadla byla plně přizpůsobena proudovému motoru. Díky tomu měl nový letoun malé rozměry a nízký podvozek. Ocasní plochy byly neseny dvěma štíhlými nosníky. 20. září 1943 vzletl první prototyp nového letounu neoficiálně pojmenovaného Spider Crab ke svému prvnímu letu. V pilotní kabině seděl G. de Havilland jun. Zkoušky byly úspěšné a v květnu 1944 byla objednána první série 120 kusů nových stíhaček, objednávky byly ale průběžně zvyšovány. Sériové stroje vyráběla v licenci firma English Electric, firma de Havilland byla vytížena výrobou Mosquit. RAF zamítlo označení Spider Crab a nové stíhačky dostaly jméno Vampire Mk.I.

K prvním bojovým jednotkám byly Vampire zařazeny v květnu 1945, ale do války již nezasáhly. Vývoj Vampire pokračoval dalšími verzemi, kromě verzí s motorem Goblin vznikly i verze s motorem Nene (vyráběné v Austrálii), dvoumístné noční stíhací, dvoumístné cvičné či námořní stíhací verze. Nejrozšířenějšími verzemi byly Mk.3 s výkonnější verzí Goblinu a novým tvarem ocasních ploch a FB.5. Verze FB.5 měla zkrácené rozpětí a byla schopna pozemních útoků s podvěšenou výzbrojí. Z této verze byly odvozeny exportní verze a také tropikalizovaná FB.9. Mimo britské RAF a FAA létaly Vampire v mnoha zemích, na všech kontinentech s výjimkou Antarktidy. Výčet zemí, které zařadily Vampire do výzbroje by byl velmi dlouhý. V několika zemích byl také vyráběn licenčně.

TTD Vampire FB Mk.5:

rozpětí: 12,19 m, délka: 9,37 m, max. rychlost: 855 km/h, dolet: 1960 km, dostup: 13 045 m, stoupavost: 24,4 m/s, výzbroj: 4x kanón ráže 20 mm, rakety či bomby do váhy 500 kg

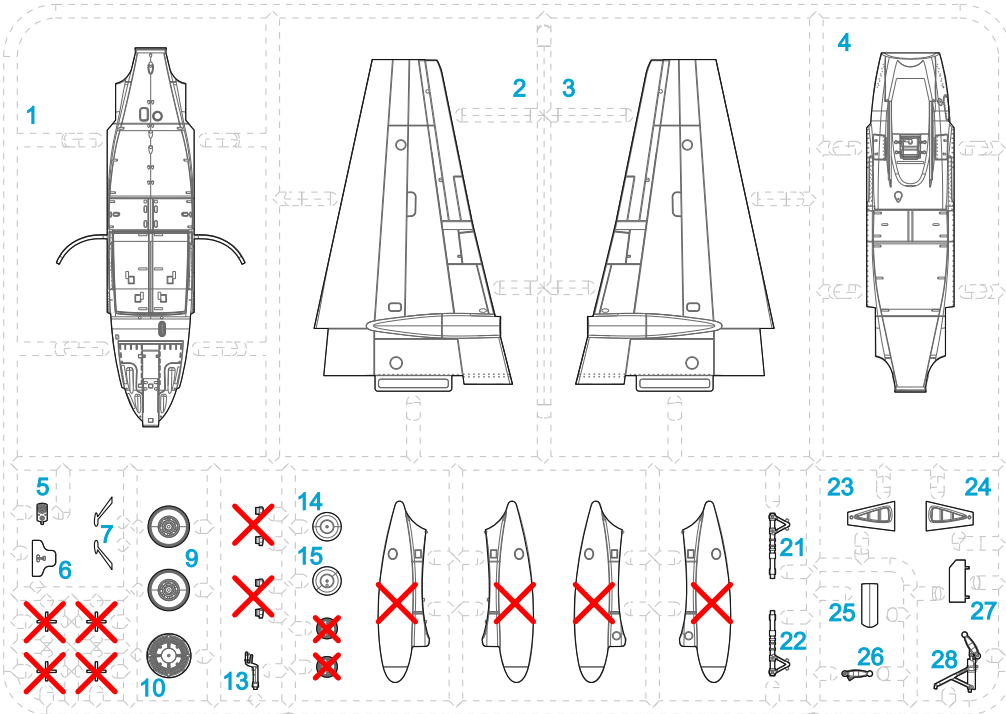
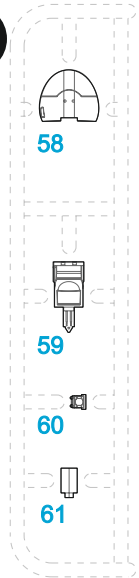
A**E**

Tento díl nepoužít
 X - Do not use this part

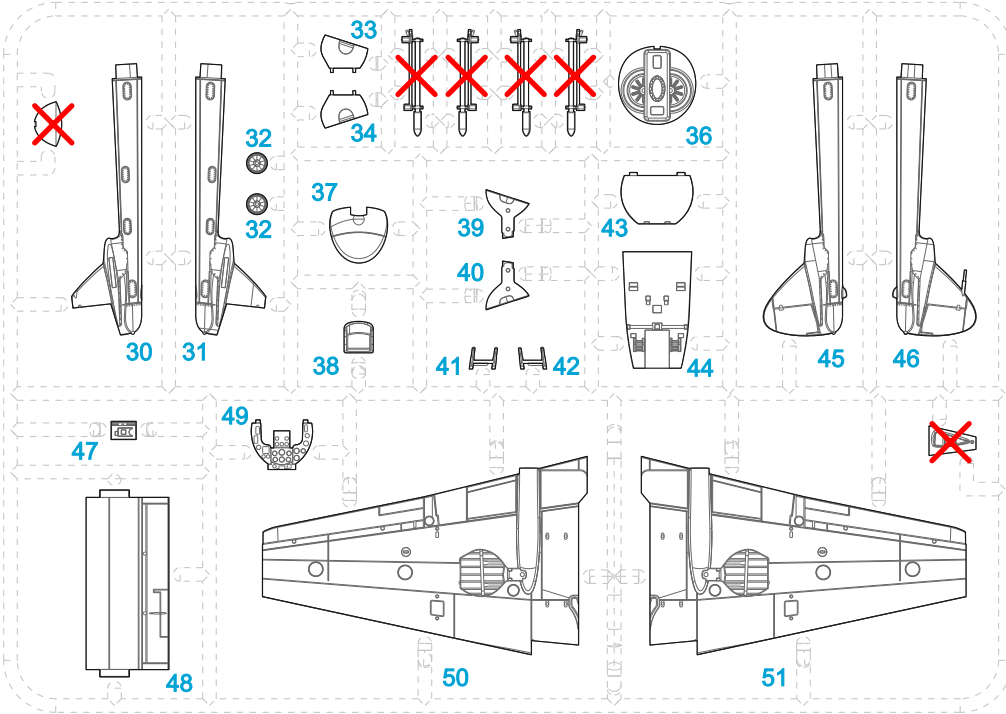
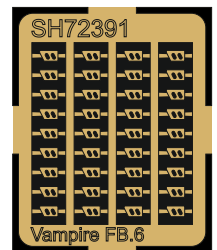
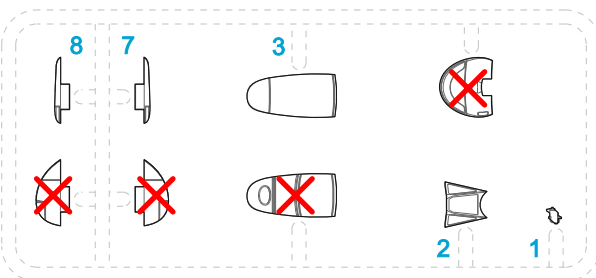
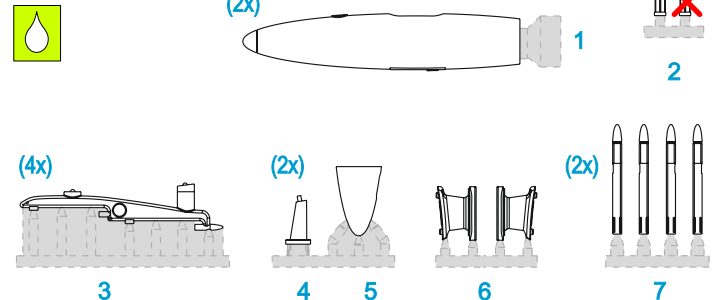
B**PE Parts****C****CLEAR Parts (CP)****PUR parts****SYMBOLS**

MOŽNOST VOLBY
 OPTIONAL
 NACH BELIEBEN
 OPTION



POUŽIT KYANOAKRYLÁTOVÉ LEPIDLO
 INSTANT CYANOACRYLATE GLUE
 ZYANOAKRYLÁTKLEBER
 ADHÉSIF CYANOACRYLAT



OHNOUT
 BEND
 BIEGEN
 COURBER



ZHOTOVIT NOVÉ
 SCRATCH BUILD
 FERTIGSTELLEN
 ACHEVER



ŘEZAT/VRTAT
 CUT OFF/DRILL
 ENTFERNEN
 DETACHER

GSI
 colours code

NATRÍT
 COLOUR
 FARBEN
 PEINDRE

1

before 1960

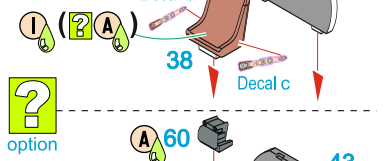

1960 and later

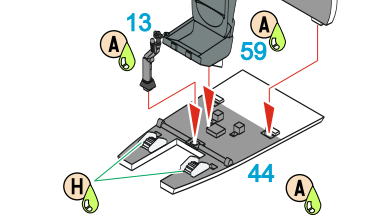

2

STEP 1

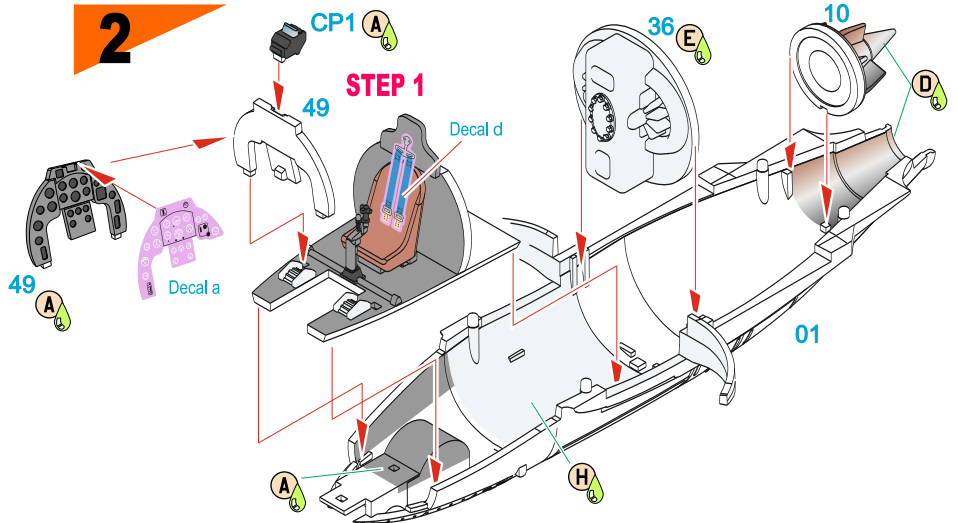

3

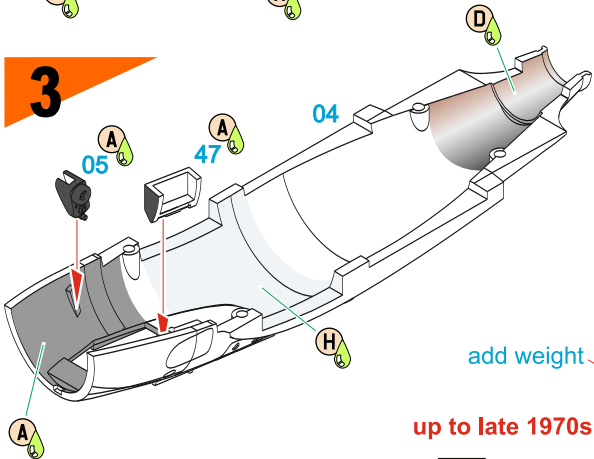

4

STEP 3

add weight
up to late 1970s

?
option
1980 and later

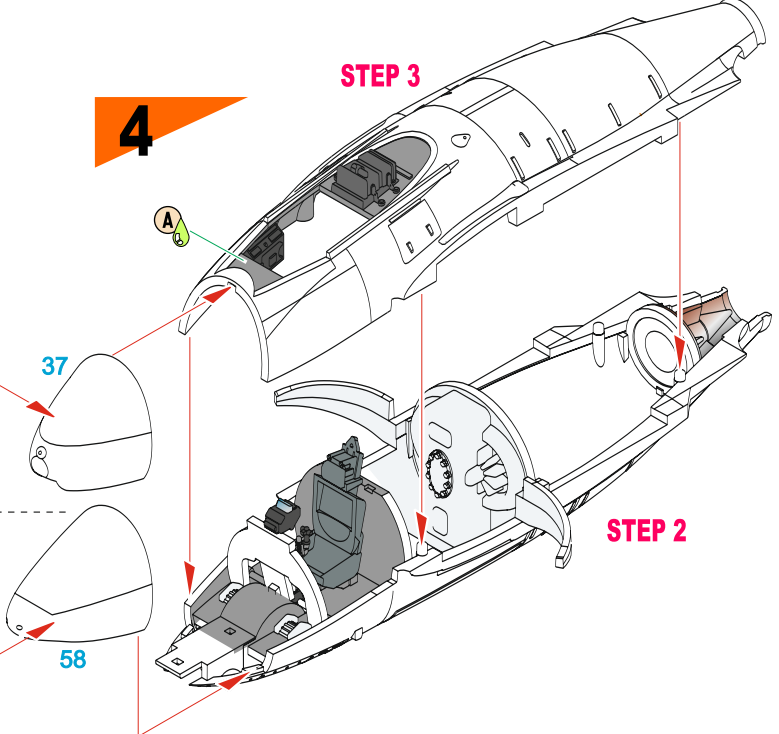

5

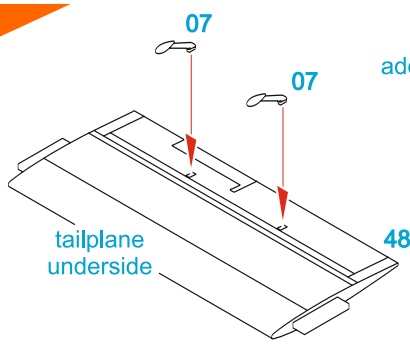

6

03
opposite
02

50
opposite
51

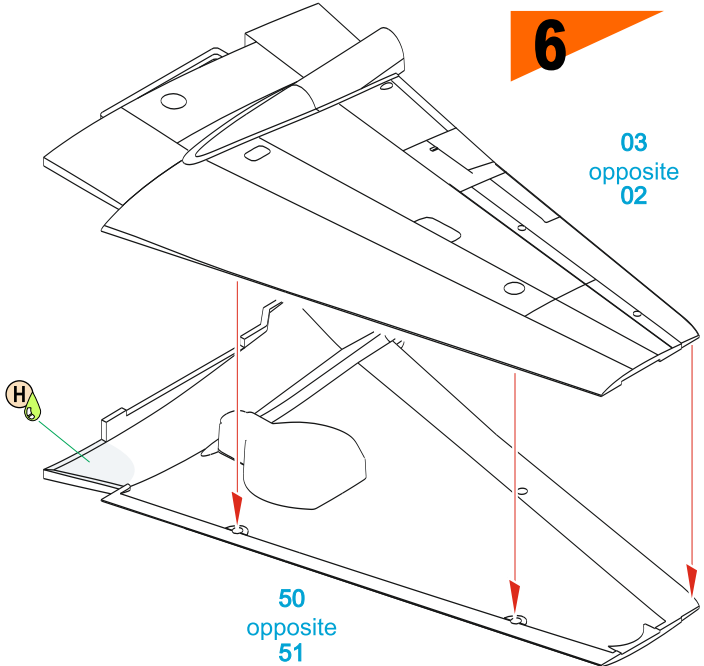

Barvy GUNZE/ GUNZE Colour No.

A	Černá / BLACK	H12/C33
B	Olivově zelená / OLIVE GREEN	H52/C12
C	Barva pneu / TIRE BLACK	H77/C137
D	Opálený kov / BURNT METAL	H76/C61
E	Chromově stříbrná / CHROME SILVER	MC211
F	Červená čirá / CLEAR RED	H90/C47
G	Modrá čirá / CLEAR BLUE	H93/C50
H	Hliník / ALUMINIUM	H8/C8
I	Červenohnědá / RED-BROWN	H47/C41
J	Bílá / WHITE	H1/C1

7

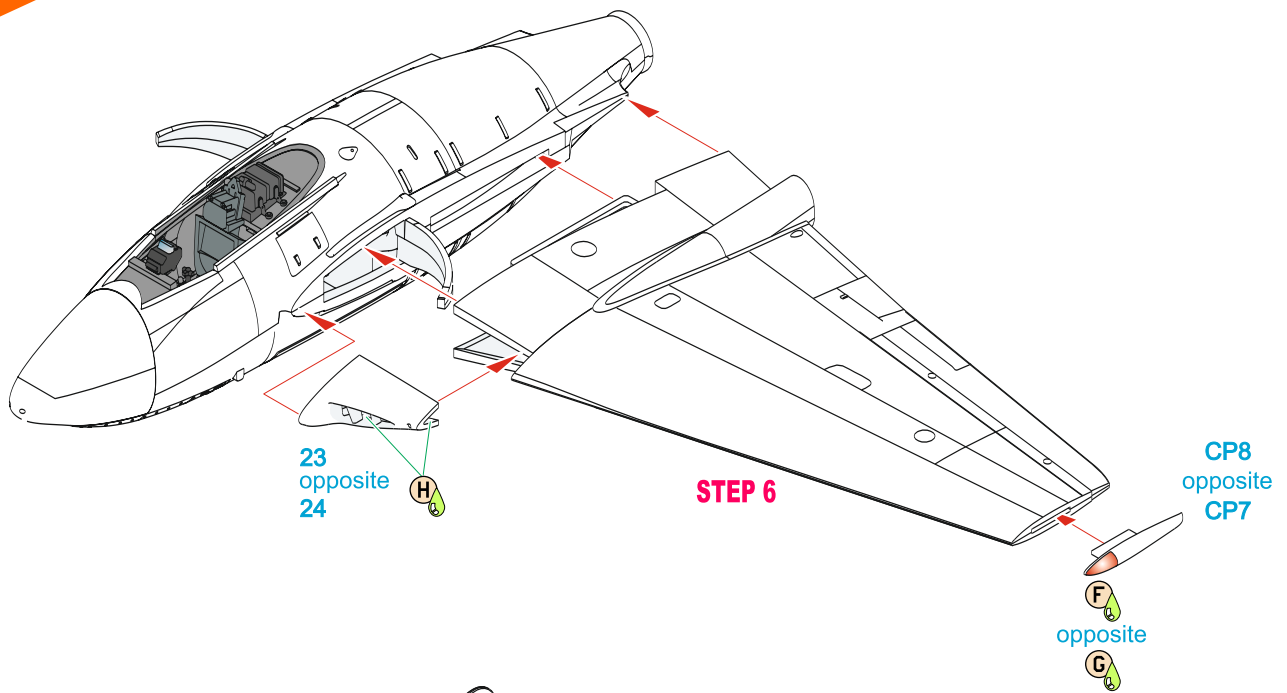

8

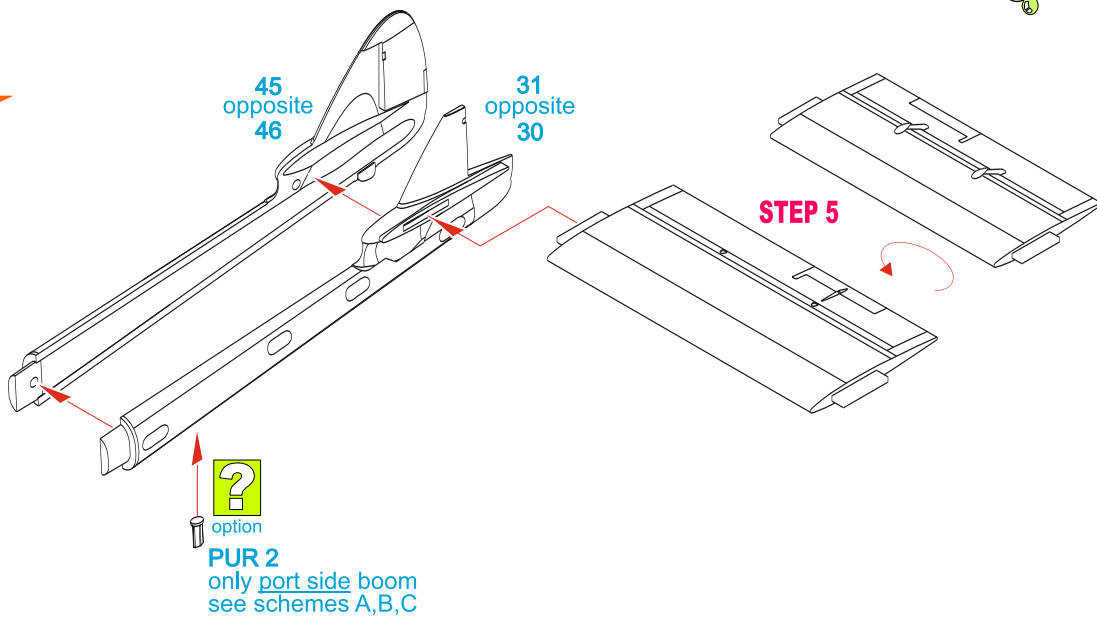

9

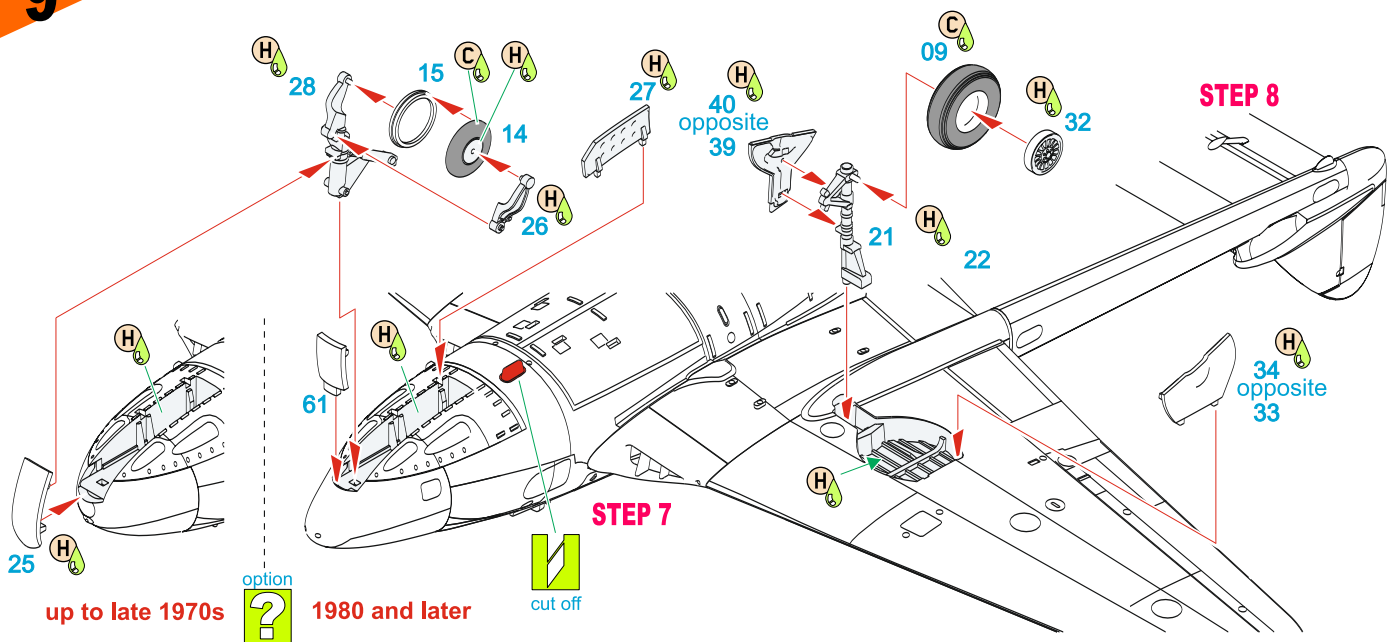

10

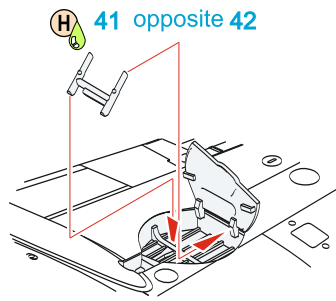

11

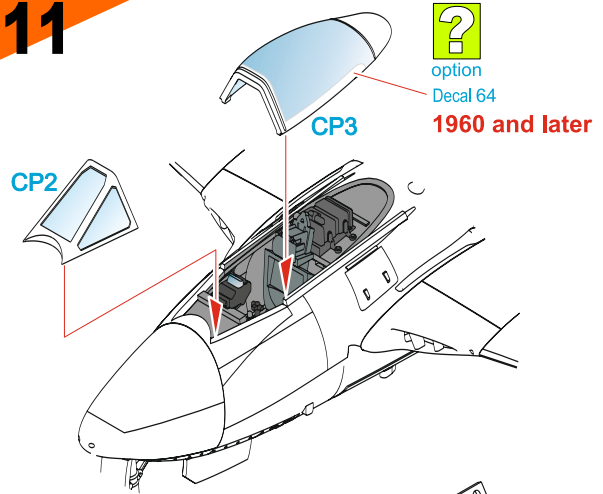

12

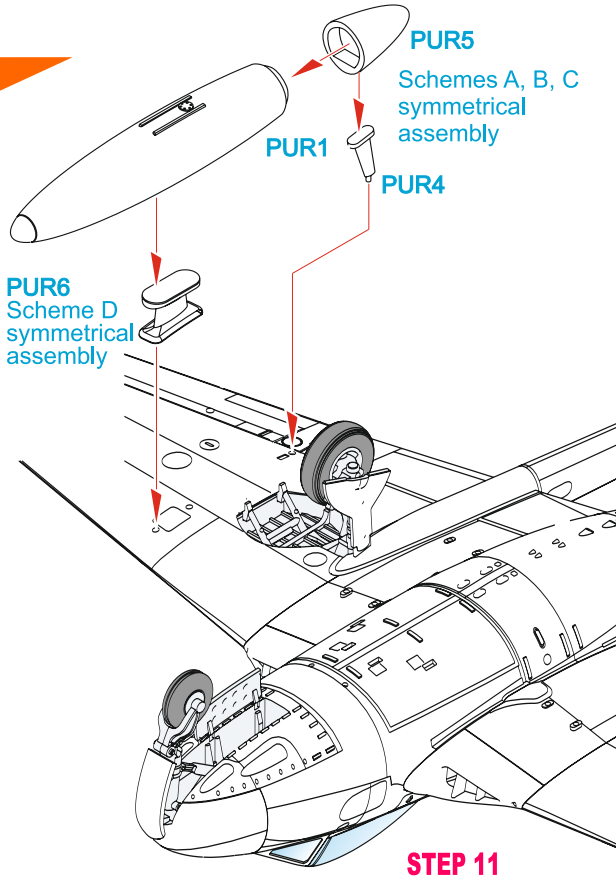

13

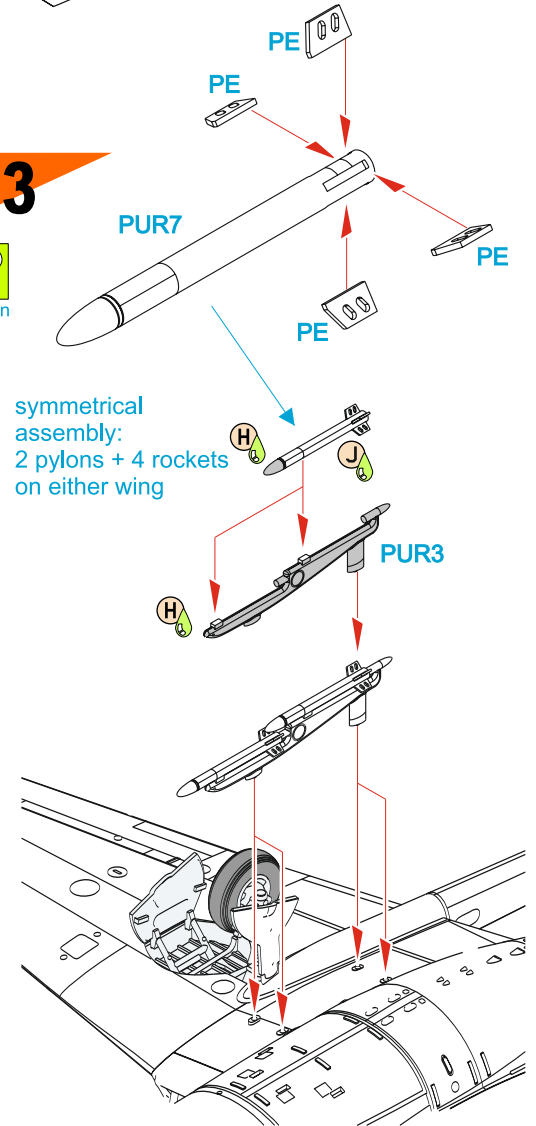

To raise the detail levels of your Vampire model, why not purchase also K72029 photo etched detail set and Q72325 Vampire Mainwheels and Nosewheel

Ask your retailer or buy on-line at www.specialhobby.eu or www.cmkkits.com

Q72325
Vampire Mk.5/9/T.11 Mainwheels and Nosewheel

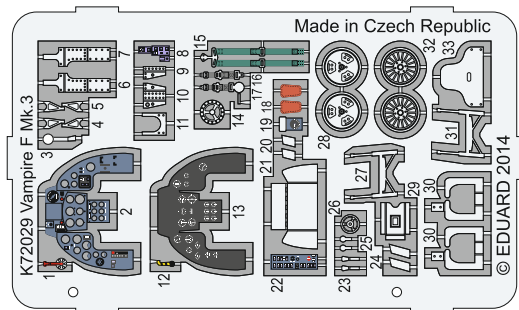

Vampire FB.6, J-1082, Zielfliegerkorps 5 (Aerial Target Corps) at Sion, Flugwaffe (Swiss Air Force), 1980s. Vampires allocated to this unit were used as target markers for instructional and refresher courses for military personnel assigned to anti-aircraft artillery units. Dayglo Orange stripes on the fuselage nacelle and wings were later repainted in bright red. (See Scheme A2)

Vampire FB.6, J-1082, Zielfliegerkorps 5, základna Sion, Flugwaffe, 80.léta. Vampiry přidělené této jednotce imitovaly vzdušné cíle při výcviku obsluh protiletadlového dělostřelectva. Výrazné oranžové pruhy na trupové gondole a křídlech byly v pozdějším období přetřeny jasně červeným odstínem. (viz Schéma A2)

Scheme A1

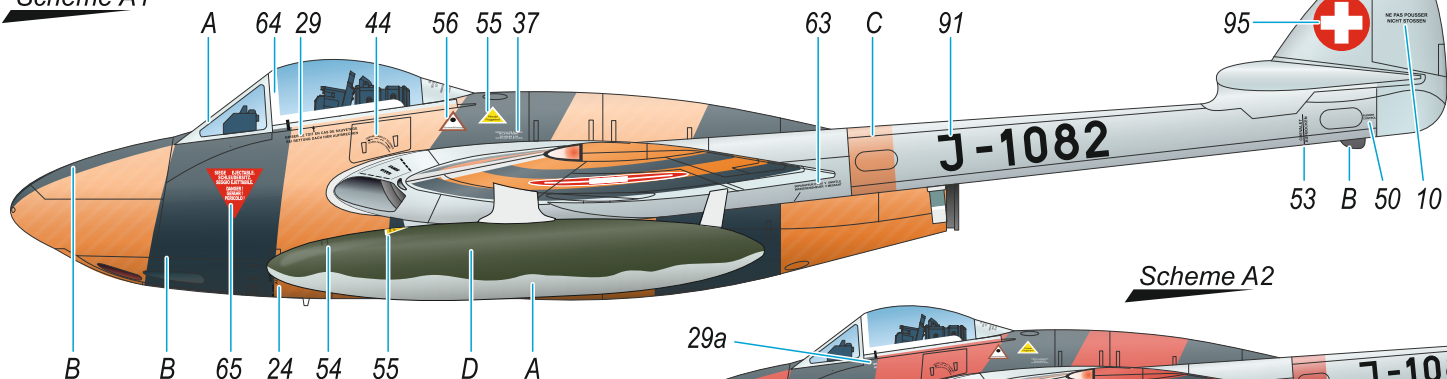

Scheme A2

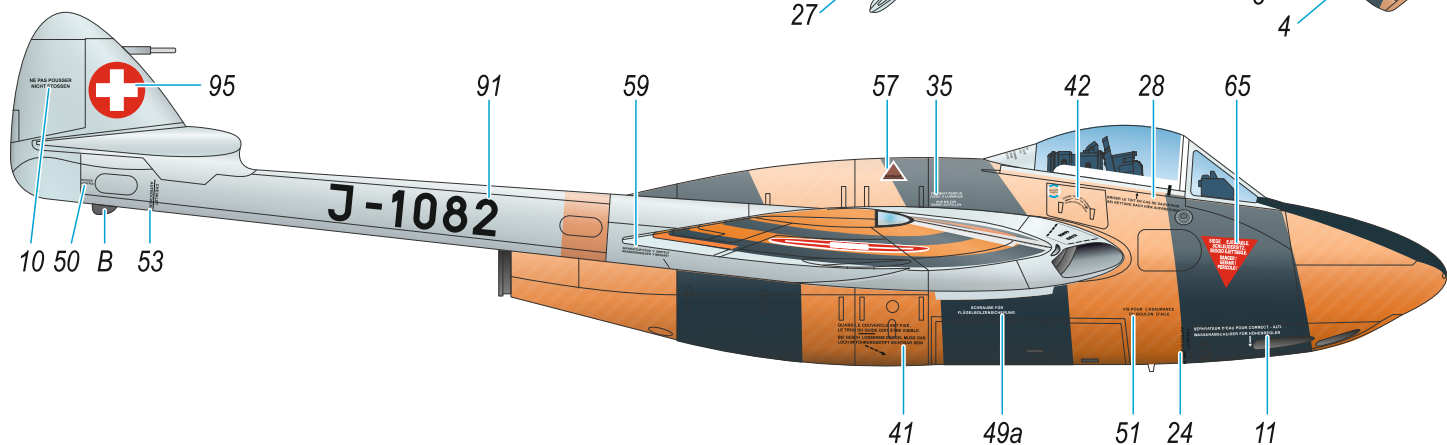
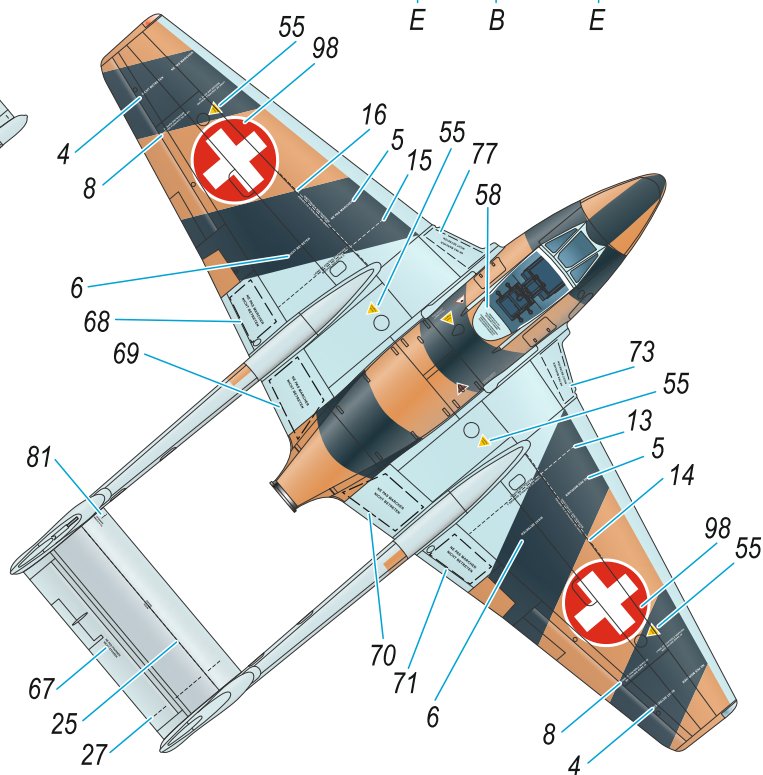
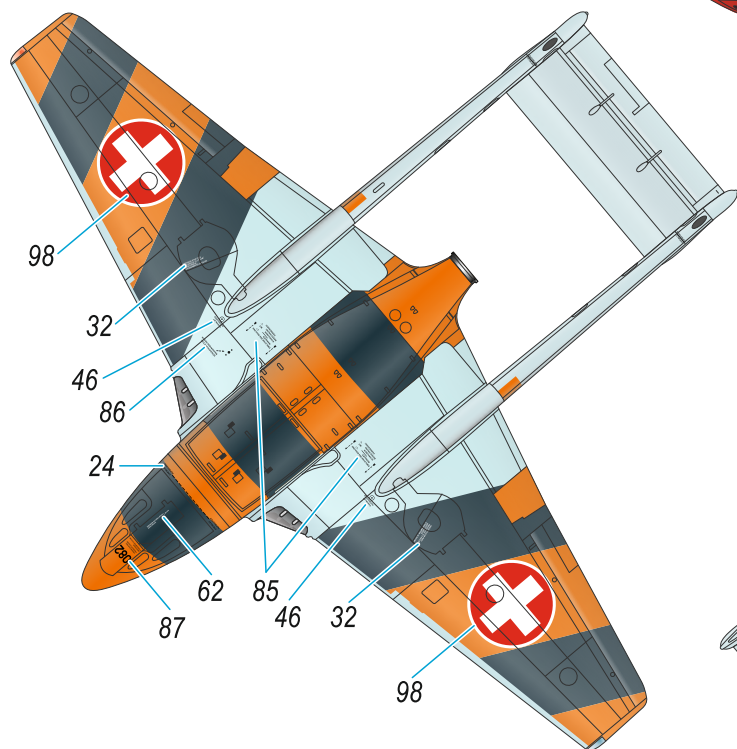
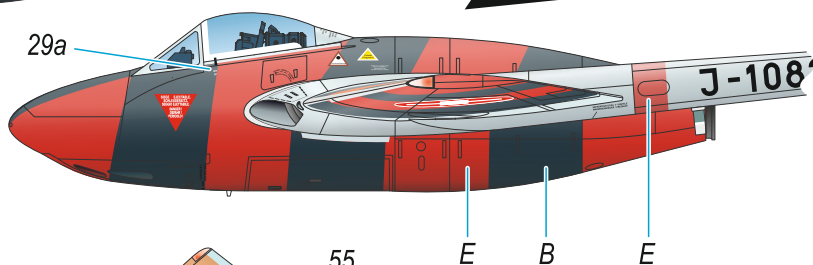

- | | | | | |
|---|------------------------------------|--|---|---------------------------------|
| A Aluminium Dope
hliníkový lak
H8+11/C8+62 | B Black
černá
H12/C33 | C Dayglo Orange
Dayglo oranžová
H/C98 | D Olive Green
olivově zelená
H52/C12 | E Red
červená
H/C3 |
|---|------------------------------------|--|---|---------------------------------|

Vampire FB.6, J-1156, one of indigenously-built machines but fitted with an original British engine. Emmen, Flugwaffe (Swiss AF), 1984.

Vampire FB.6, J-1156 byl jeden z Vampirů vyrobených ve přímo ve Švýcarsku, ale vybavených britským motorem. Základna Emmen, Flugwaffe, 1984.

Scheme B

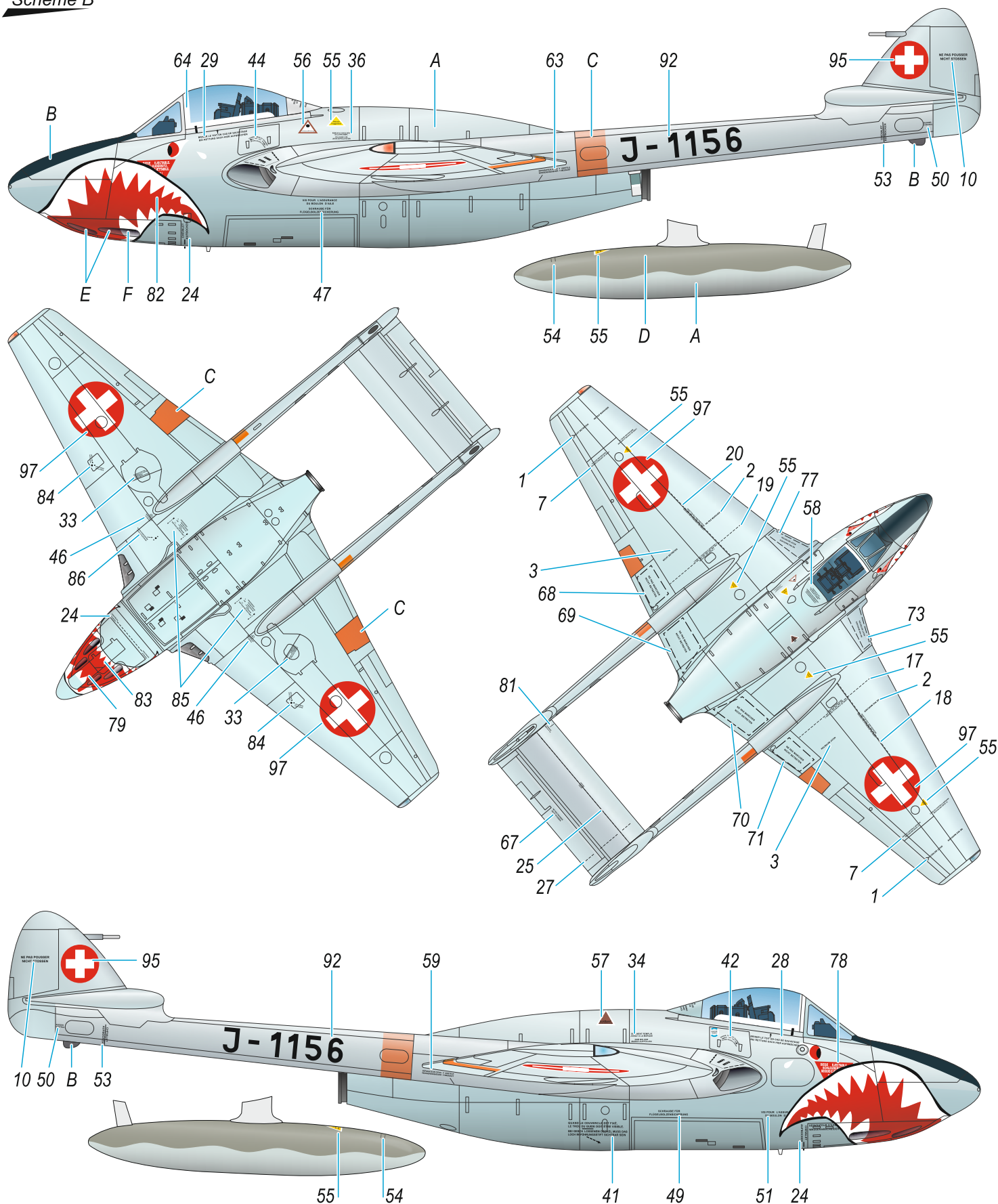

- | | | | | | |
|---|------------------------------------|--|---|---------------------------------|--------------------------------|
| A Aluminium Dope
hliníkový lak
H8+11/C8+62 | B Black
černá
H12/C33 | C Dayglo Orange
Dayglo oranžová
H/C98 | D Olive Green
olivově zelená
H52/C12 | E Red
červená
H/C3 | F White
bílá
H/C1 |
|---|------------------------------------|--|---|---------------------------------|--------------------------------|

Vampire FB.6, J-1154, 2 Sqn, Dubendorf, Flugwaffe (SwissAF), 1980s.

Vampire FB.6, J-1154, 2 Sqn, Dubendorf, Flugwaffe, 80.léta.

Scheme C

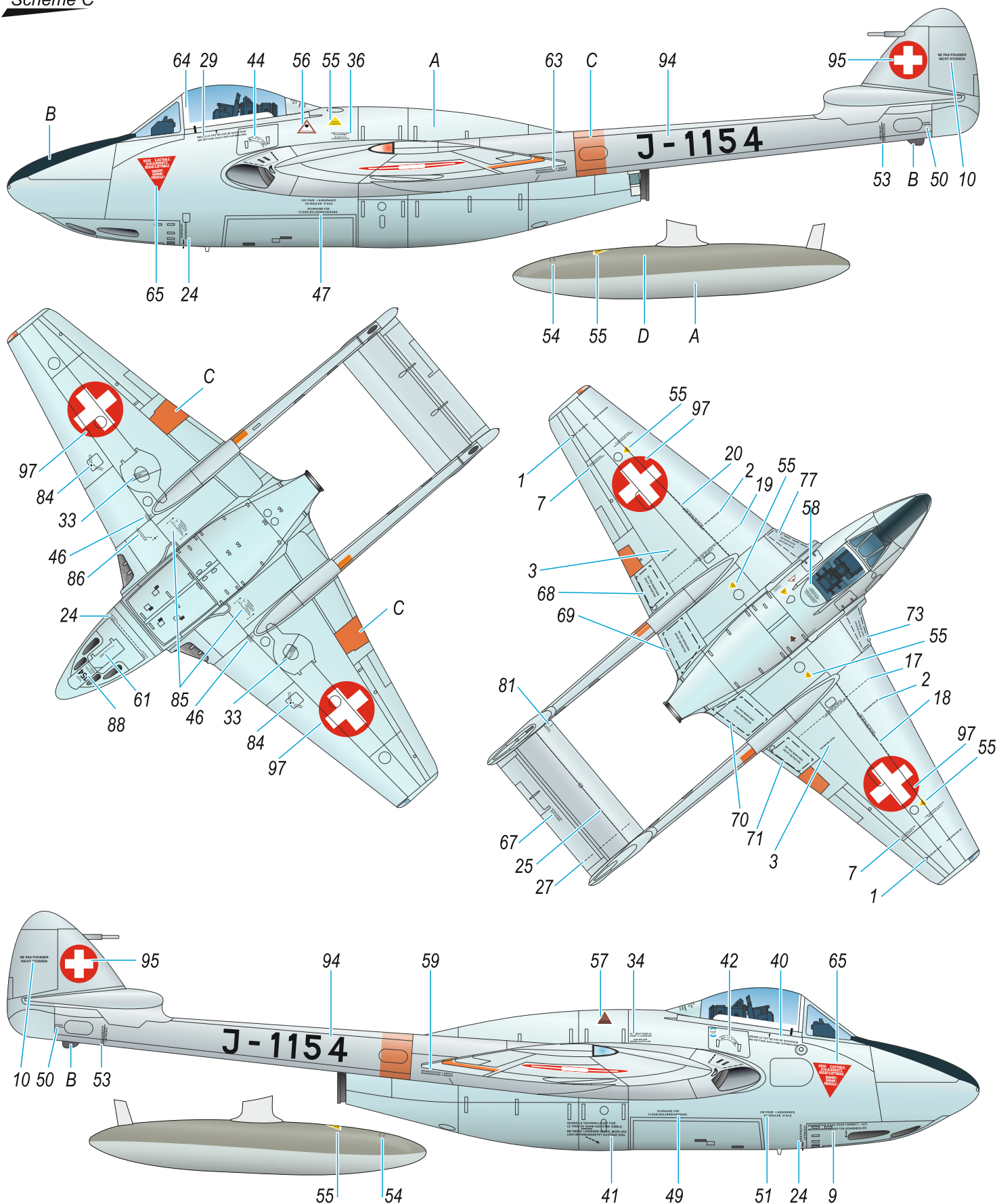

- | | | | |
|---|------------------------------------|--|---|
| A Aluminium Dope
hliníkový lak
H8+11/C8+62 | B Black
černá
H12/C33 | C Dayglo Orange
Dayglo oranžová
H/C98 | D Olive Green
olivově zelená
H52/C12 |
|---|------------------------------------|--|---|

Vampire FB.6, J-1010, 2 Sqn, Dubendorf, Flugwaffe (SwissAF), 1964.

Vampire FB.6, J-1010, 2 Sqn, Dubendorf, Flugwaffe, 1964.

Scheme D

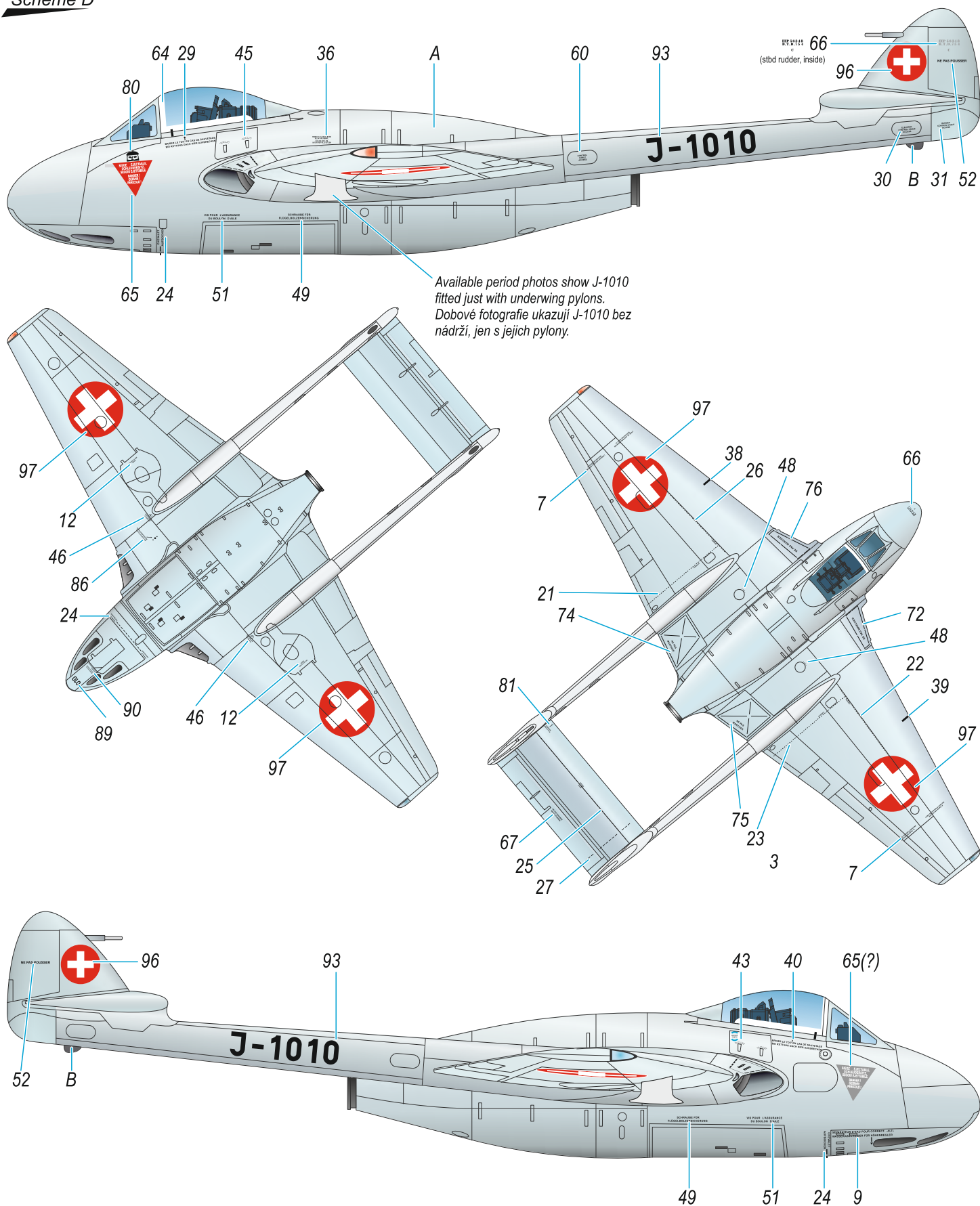

Available period photos show J-1010 fitted just with underwing pylons. Dobové fotografie ukazují J-1010 bez nádrží, jen s jejich pylony.

- A** Aluminium Dope
hliníkový lak
H8+11/C8+62
- B** Black
černá
H12/C33

P-40E Warhawk

1/72

'Claws and Teeth'



SH72338

Special
HOBBY

CMK SETS
P-40
WARHAWK
KITTYHAWK
SPECIAL HOBBY



Q72293 1/72
P-40E/F/K/L/M
and N-1 Seat



Q72294 1/72
P-40N-5 through
N-40 Seat



Q72 299
P-40E, F, K
and N-1 Se



Q72300 1/72
P-40N-5 through
N-40 Seat with
Belts



Q72 302 1/72
Kittyhawk I, Ia, II,
IIa and III Seat with
Sutton Harness



Q72303 1/72
Kittyhawk IV Seat
with Sutton
Harness



Q72295 1/72
P-40 Wheels
Diamond Tread



Q72296 1/72
P-40 Wheels Block
Tread



Q72301 1/72
P-40 Cockpit Sidewalls
and Control Column



Q72297 1/72
P-40 Wheels
Cross Tread



Q72298 1/72
P-40 Wheels Diamond
and Hole Tread

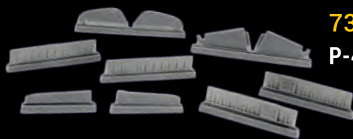

7386 1/72
P-40 Control Surfaces

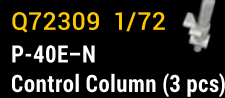

Q72309 1/72
P-40E-N
Control Column (3 pcs)



7389 1/72
P-40E/K/M/N Armament Set



7387 1/72
P-40
Undercarriage Set



7388 1/72
P-40 Engine Set



7390 1/72
P-40N Engine Set



facebook.com/specialhobby

WWW.SPECIALHOBBY.EU

WWW.CMKKITS.COM

Special
HOBBY



ATTRACTIVE 1/72 SCALE CMK SETS



7368
AN/APS-4 Radar Pod (1 pc)



7426
A-20G/H/K/J Havoc/Boston Mk.IV/V
Cockpit



7427
A-20G/H/K/J Havoc/Boston Mk.IV/V
Gun Turret



7429
B-25C/D Nose Compartment
(Bomb Aimer's Station)

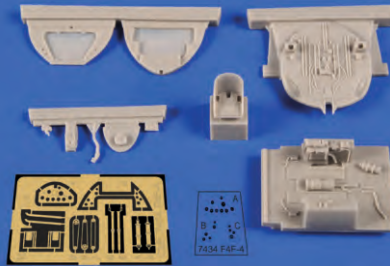

7434
F4F-4 Wildcat Interior



7435
F4F-4 Wildcat Dinghy Set



7442
AN/M2 Browning Cal. .50/12.7 mm
Fixed-Mounted Aircraft Gun (4 pcs.)



7445
B-25C/D Dinghy

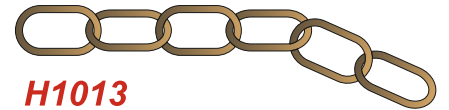

H1013
Coarse Brass Chain
– suitable for 1/35 scale

H1014
Medium Brass Chain
– suitable for 1/48 scale

H1015
Fine Brass Chain
– suitable for 1/72 scale



H1011
CMK sanding
stick four
different grit
of sanding
papers
on one
sanding
stick.



The Razor Saw with Handle (cat. n. H1010) is a great tool for cutting both plastic and resin. CMK also offers a wide variety of coarse/medium/fine saws.

H1000 Ultra smooth and extra smooth saw (2 sides – 70 teeth / 42 teeth) 1 pc

H1001 Ultra smooth saw (both sides – 70 teeth / 70 teeth) 1 pc

H1002 Very smooth saw (both sides – 42 teeth / 42 teeth) 1 pc

H1003 Smooth saw (both sides – 31 teeth / 31 teeth) 1 pc

H1004 Ultra smooth and extra smooth saw (2 sides – 70 teeth / 42 teeth) 5 pcs

H1005 Ultra smooth saw (both sides – 70 teeth / 70 teeth) 5 pcs

H1006 Very smooth saw (both sides – 42 teeth / 42 teeth) 5 pcs

H1007 Smooth saw (both sides – 31 teeth / 31 teeth) 5 pcs

H1010 Razor Saw with Handle



SH72384

JA-37 Viggen Fighter

1/72



Resin sets for your Viggen



Q72343
SAAB Viggen Thrust Reverser



Q72344
SAAB Viggen
Air Brakes Set



Q72345 SAAB Viggen Wheels

Q72346
SAAB Viggen
Ejection
Seat

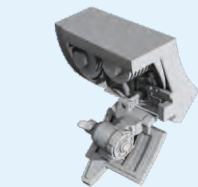

Q72347
SAAB Viggen
Ram Air Turbine (RAT)



7328
Bofors m/70 Rocket pod (2 pcs)

F72352
SK-37/SK-37E Viggen
Instructor / Operator
(seated in rear cockpit)
and Pilot Climbing Ladder
into cockpit



facebook.com/specialhobby
WWW.SPECIALHOBBY.EU
WWW.CMKKITS.COM

