

**4420 1/48** **Gloster Meteor F Mk.8/9**  
**Main Fuel Tank**  
*for Airfix kit*

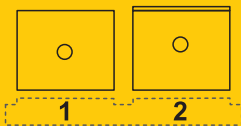

**PUR - Polyurethane parts**

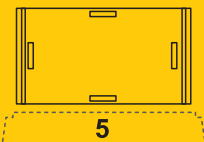

© Special Hobby 2021

Díly ohnuté popř. pokroucené vlivem teplotních změn a stárnutí materiálu, mohou být narovnány do požadovaného tvaru pomocí proudu teplé vody nebo vzduchu (fén na vlasy). K lepení použít kyanoakrylátové lepidlo! Kontaktní plochy doporučujeme před lepením odmastit. Různé drátky a tyčinky nejsou přiloženy.

*Parts slightly distorted and bent owing to temperature changes or due to material ageing can be straightened to requested shape by hot water or hot air jet (hair dryer). This process can be repeated till result is entirely satisfactory. For best result use cyanoacrylate glue! Contact areas ungrease is recommended before gluing. Wires and rods not included.*

**Visit our official website and e-shop at**

**[www.cmkkits.com](http://www.cmkkits.com)**

**[www.specialhobby.eu](http://www.specialhobby.eu)**

**[www.facebook.com/specialhobby/](https://www.facebook.com/specialhobby/)**

**OTHER 1/48 METEOR SETS**



Special Hobby, Mezilesí 718, Praha 9, 193 00, Czech Republic  
 e-mail: [office@specialhobby.eu](mailto:office@specialhobby.eu)

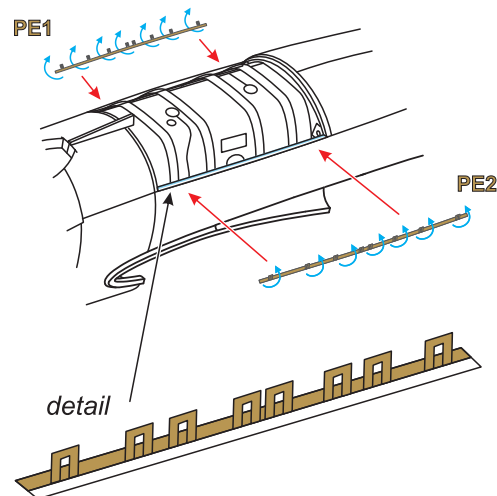
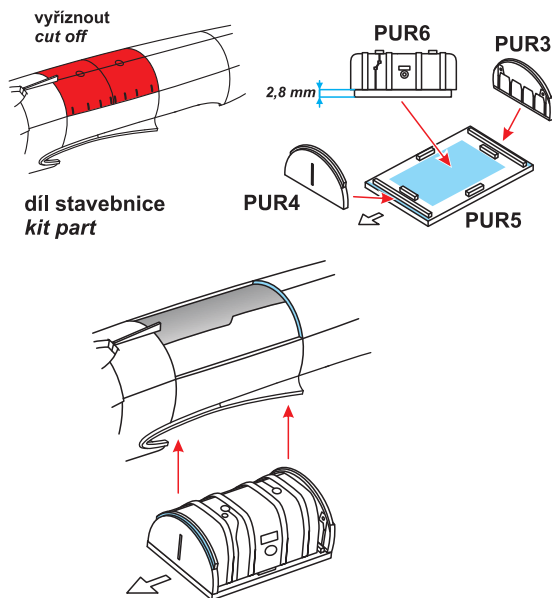

**kryty (PUR1 a 2) odložte vedle modelu**  
**put covers (PUR1 and 2) beside the model**