

1/72

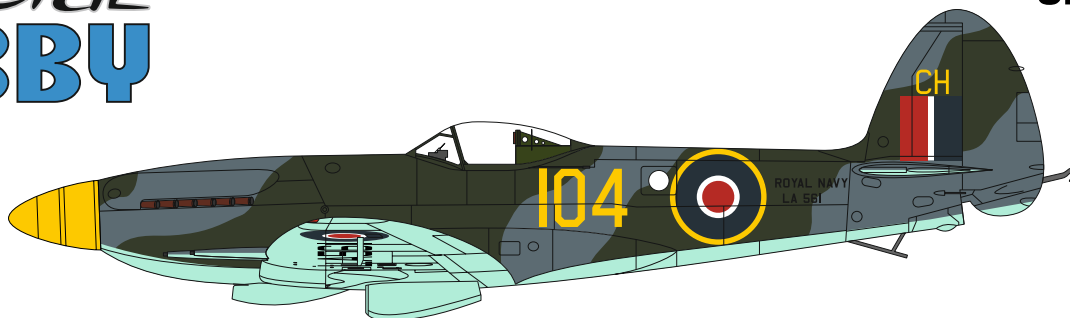

Seafire Mk. 46

GB

The Seafire version development copied Spitfire ones but with delay. In fact every new improvement introduced in Spitfire development line meant that similar one will be introduced to Seafire production line. Such as Griffon engine introduction, tear drop shaped canopies or other structural changes.

Last version of Spitfires, e.g. Mk. 21, 22 and 24, sometimes called Second Generation Spitfires, had its equal naval counterparts in Seafires Mk.45, 46, 47. While Seafire Mk.45 was in fact naval version of Spitfire Mk.21, Seafire Mk.46 was modified from Spitfire Mk.22 version. Spitfire Mk.22's airframe was at the end of the fuselage equipped with stinger type arrestor hook; "type Y" wing remained unchanged as on Spitfire, including its armament. The fact that the wing didn't have the folding mechanism limited the use of this new version aboard the aircraft carriers. Unlike Spitfire Mk.22, Seafire Mk.46 was powered by series 80 Griffon engine driving contra rotating six bladed propellers (Spitfire Mk.22 was powered by series 60 Griffon engine driving five bladed propeller). This modification, already tested on several Seafire Mk.45 examples, eliminated the torque reaction of the standard propeller. The first prototype TM383 was in Cunliffe-Owen plant modified from Spitfire Mk.21 and test flown in September 1944. The production of 200 machines was ordered in South Marston plant. Due to the end of the war in Europe only 24 machines of this version were produced. Since the fuselage of this version was modified for photo cameras installation, these machines were designated FR.46. The production was later switched to final version Mk.47 that featured foldable wing.

Due to few produced machines and hard wing, Seafire Mk.46s served mainly from land bases in the Great Britain and were used by FAA and RNVR training squadrons.

Technical Data:

Wingspan: 11.36 m, Length: 10.52 m, Max. Speed: 700 kmh, Range: 1,500 km, Service Ceiling: 12,405 m.

CZ

Vývoj verzí letounu Seafire kopíroval se zpožděním vývoj Spitfirů. Prakticky vždy po zavedení nového prvku ve vývojové linii Spitfiru se podobná inovace objevila později u Seafirů, ať už to bylo zavedení motorů Griffon, kapkovitých kabin či jiné konstrukční úpravy. Poslední verze Spitfirů, tj. Mk. 21, 22, 24, někdy označované jako Spitfiry druhé generace měly odpovídající námořní protějšky ve Seafirech Mk.45, 46, a 47. Zatím co Seafire Mk. 45 byl navalizovaný Spitfire Mk.21, tak Seafire Mk.46 vznikl úpravou z verze Spitfire Mk.22. Drak Spitfiru Mk.22 dostal na konec trupu přistávací hák typu žihadlo, křídlo „type Y“ zůstalo stejné jako u Spitfiru, včetně výzbroje. To že bylo nesklonné ale omezovalo službu nové verze na letadlových lodích. Seafire Mk.46 dostal na rozdíl od Spitfire Mk.22 standardně motor Griffon řady 80 a protiběžnou vrtuli se šesti listy. (Spitfire Mk.22 měl motor Griffon řady 60 a vrtuli pětistou). Tato úprava, vyzkoušená již na několika Seafirech Mk.45 odstranila nebezpečný reakční moment vrtule. První prototyp TM383 vznikl přestavbou Spitfiru Mk.21 v továrně Cunliffe-Owen a zalétán byl v září 1944. Byla objednána výroba 200 ks u výrobního závodu v South Marston. Vzhledem ke konci války však bylo vyrobeno pouze 24 kusů této verze. Vzhledem k tomu, že měly trup upravený na montáž fotografických přístrojů, byly označovány FR.46. Na výrobní lince byla později nahrazeny definitivní verzí Mk.47 se sklopným křídlem.

Vzhledem k malému počtu vyrobených kusů a pevnému křídlu operovaly Seafiry Mk.46 z pozemních základů ve Velké Británii a používaly je výcvikové squadry FAA a RNVR.

Technická data:

rozpětí:11,36 m, délka:10,52 m, max. rychlost:700 km/h, dolet:1500 km, dostup:12 405 m,

DÍLY - PARTS - TEILE - PIECES

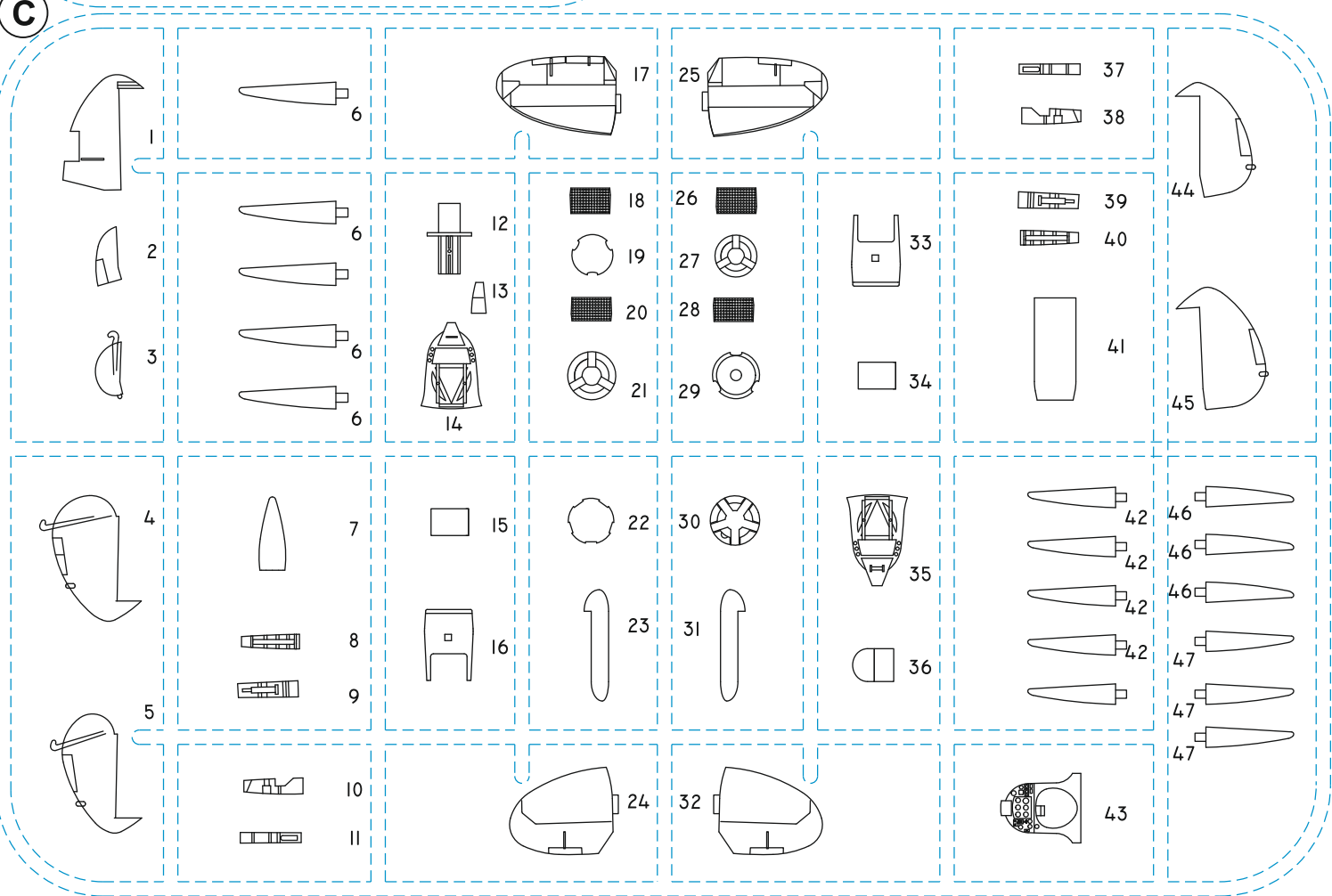
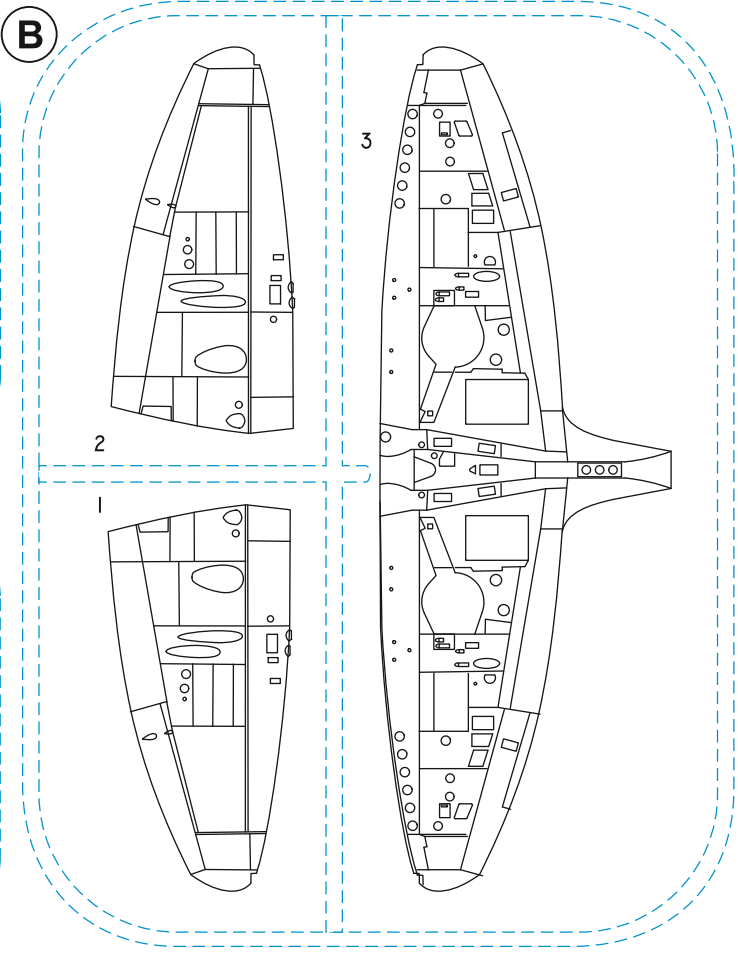
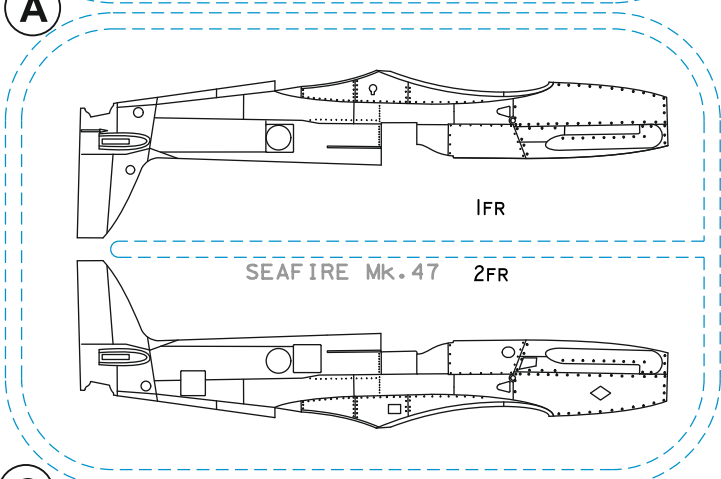
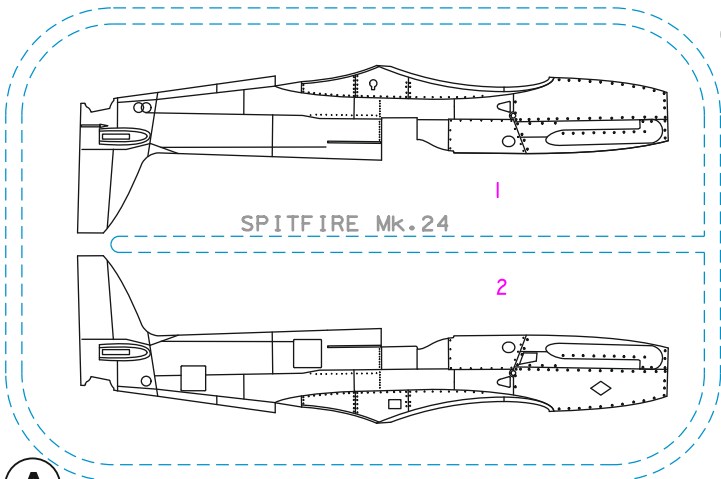

DÍLY - PARTS - TEILE - PIECES

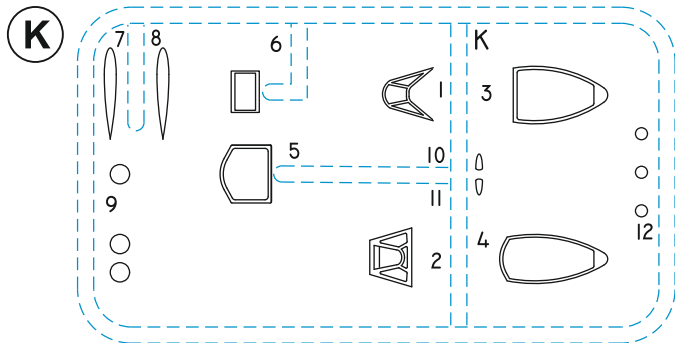
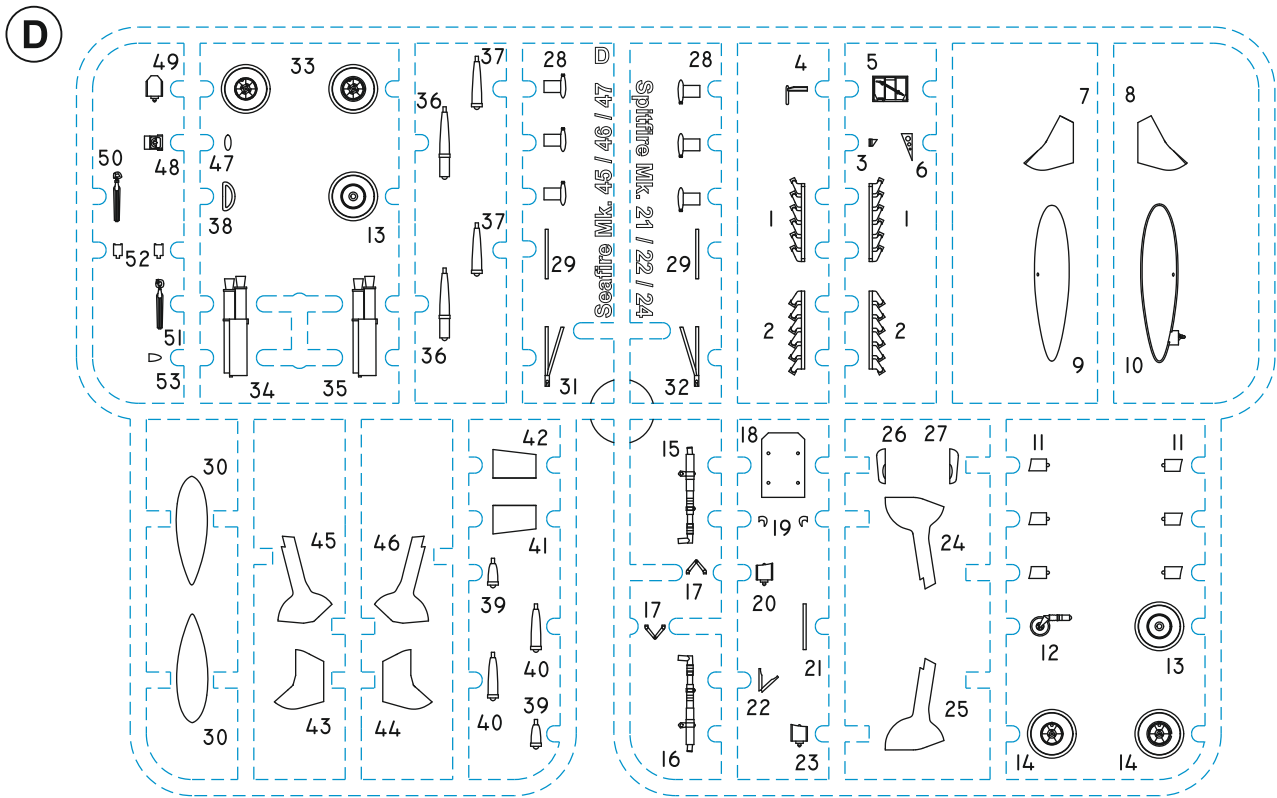

Special Hobby also offers **K72023 Spitfire 24/Seafire 46 Coloured Photo-etched parts and CMK resin sets 7225 Seafire FR.46/47 Armament and 7257 Seafire FR Mk.46 Engine for Seafire Mk.46 kit**
 Visit our website www.specialhobby.eu

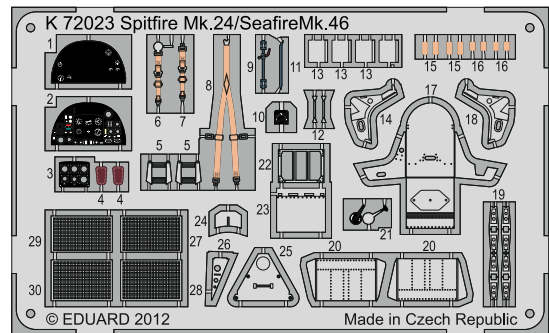

Barvy GUNZE/ GUNZE Colour No.		
A	Černá/ BLACK	H12/C33
B	Opálený kov/ BURNT IRON	H76/C61
C	Barva pneu/ TIRE BLACK	H77/C137
D	Šedozelená/ GREY GREEN	C364
E	Hliníková/ ALUMINIUM	MC218
F	Tmavý kov/ DARK IRON	MC214
G	Hnědočervená/ RED BROWN	80% H47/C41 +20% H92/C49

? + other colours on pages 10-11 (camouflage)/
 + další odstíny barev na stranách 10-11

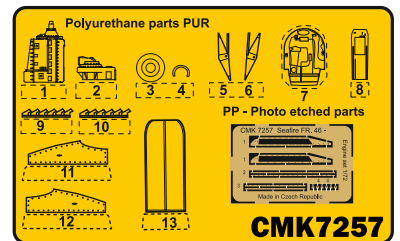
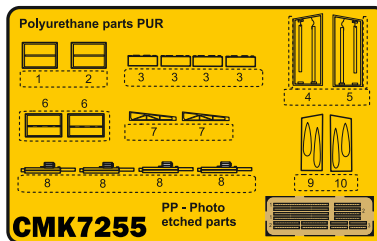

? MOŽNOST VOLBY
 OPTIONAL
 NACH BELIEBEN
 OPTION

POUŽÍT KYANOAKRYLÁTOVÉ LEPIDLO
 INSTANT CYANOACRYLATE GLUE
 ZYANOAKRYLÄTKLEBER
 ADHÉSIF CYANOACRYLAT

SYMBOLS

OHNOUT
 BEND
 BIEGEN
 COURBER

ZHOTOVIT NOVÉ
 SCRATCH BUILD
 FERTIGSTELLEN
 ACHEVER

ŘEZAT/VRTAT
 CUT OFF/DRILL
 ENTFERNEN
 DETACHER

GSI
 colours code

NATŘÍT
 COLOUR
 FARBEN
 PEINDRE

SESTAVA - ASSEMBLY - BAUANLEITUNG - ASSEMBLAGE

1

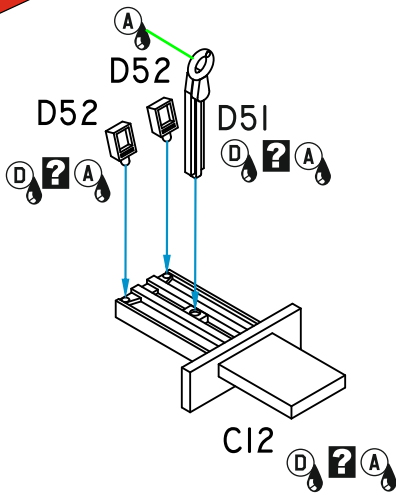

2

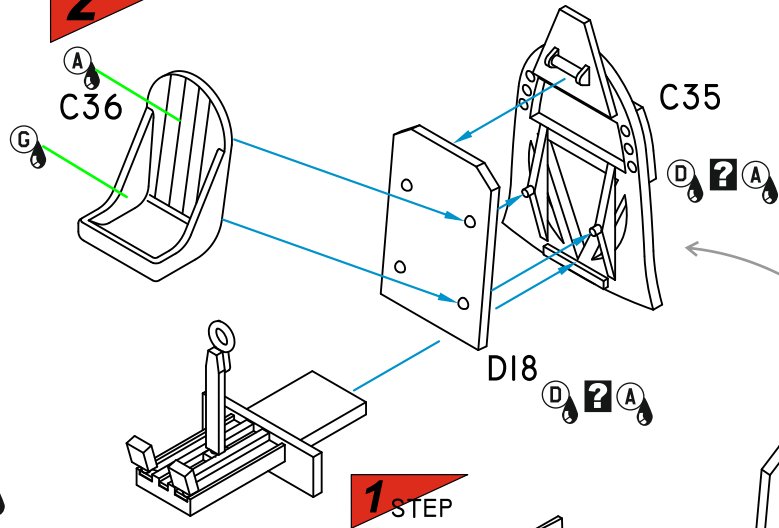

3

?

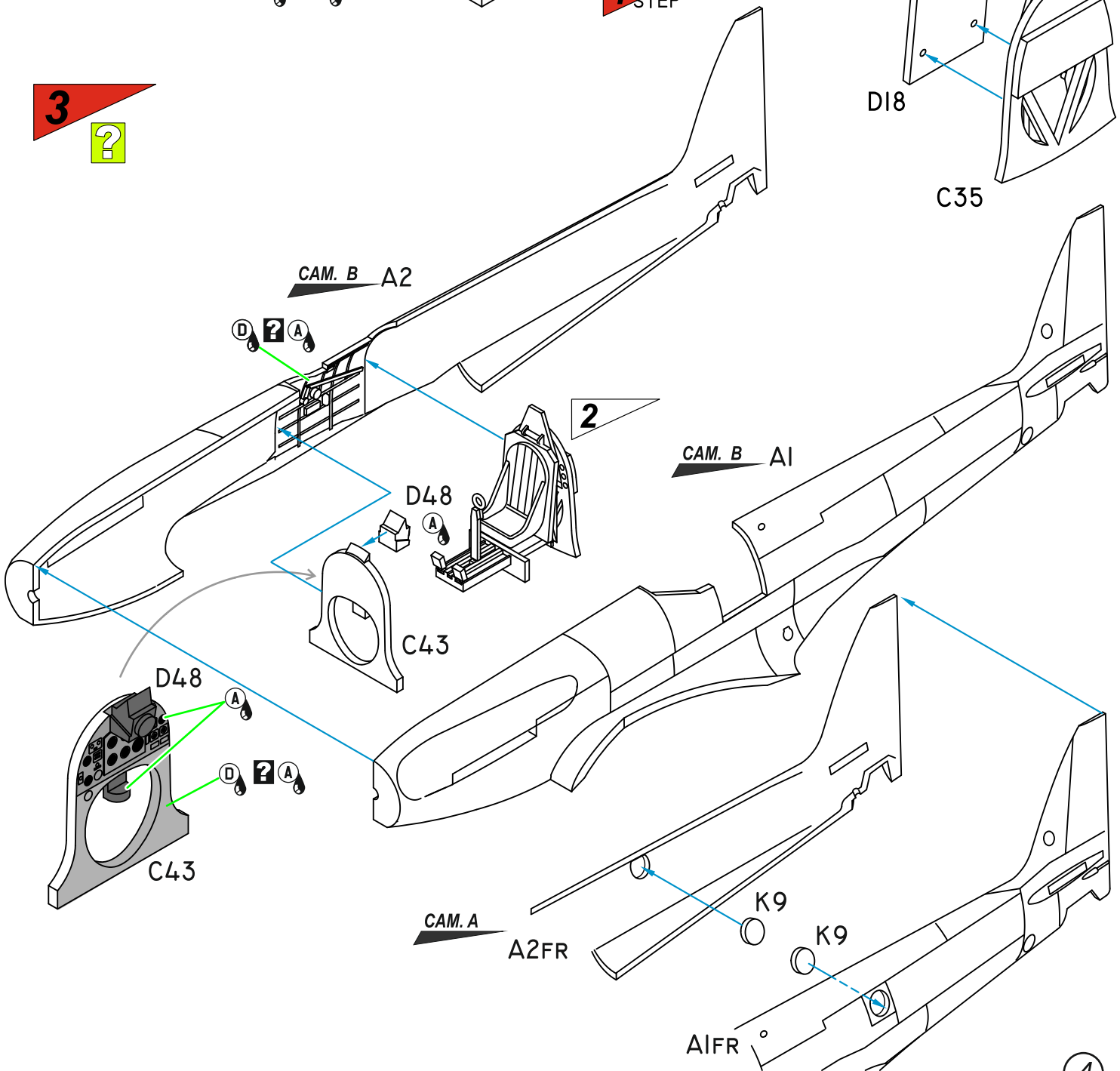

SESTAVA - ASSEMBLY - BAUANLEITUNG - ASSEMBLAGE

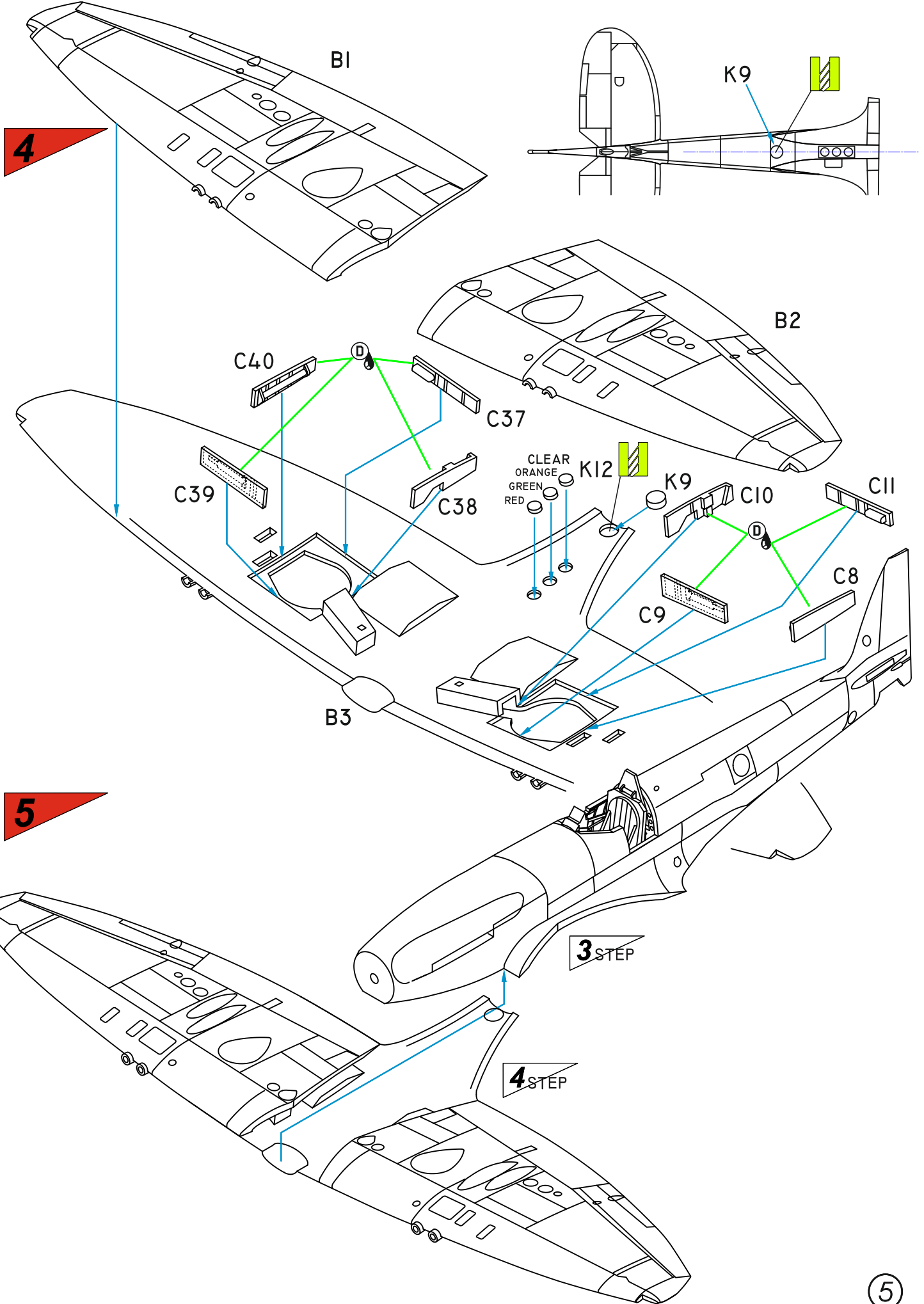

SESTAVA - ASSEMBLY - BAUANLEITUNG - ASSEMBLAGE

6

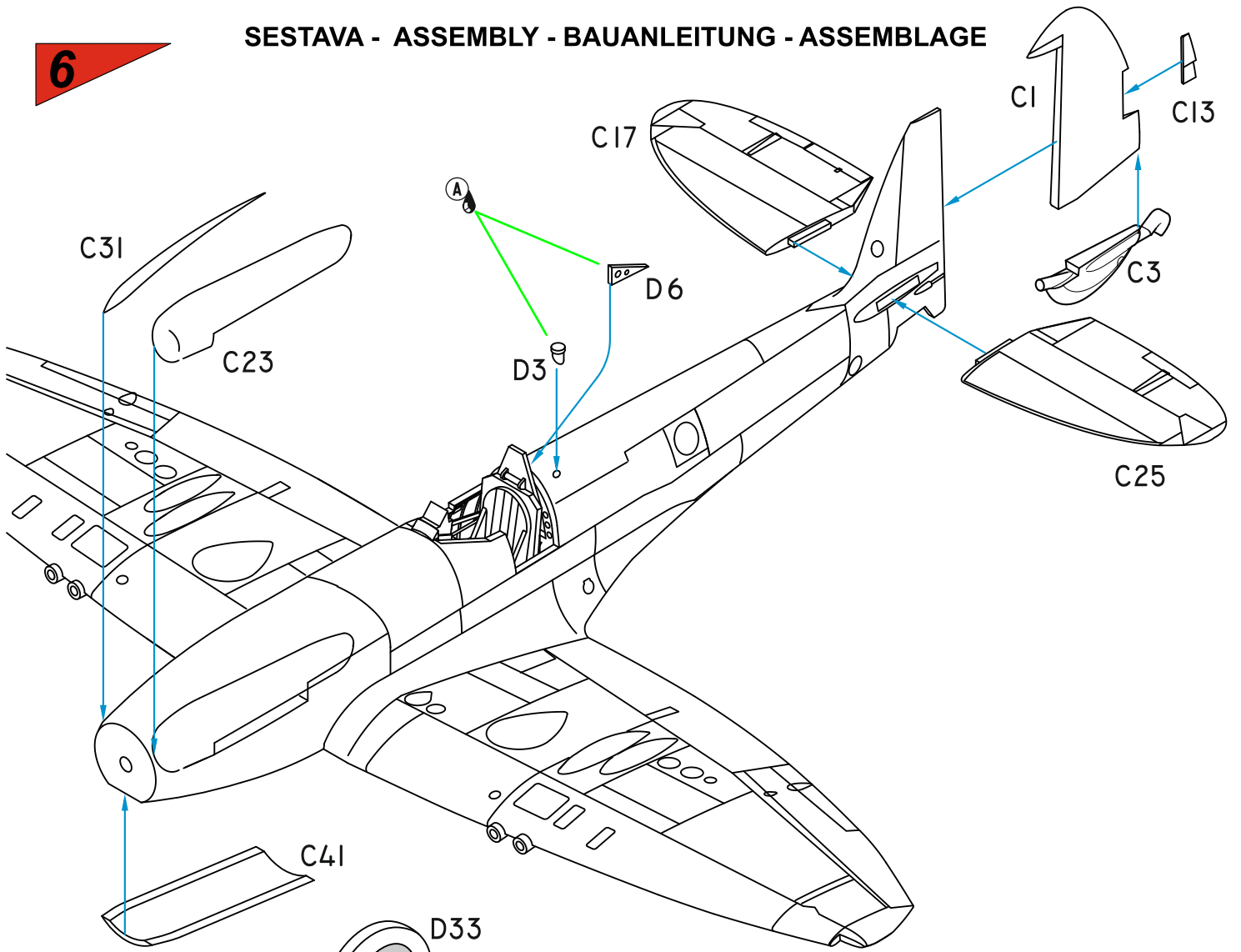

7

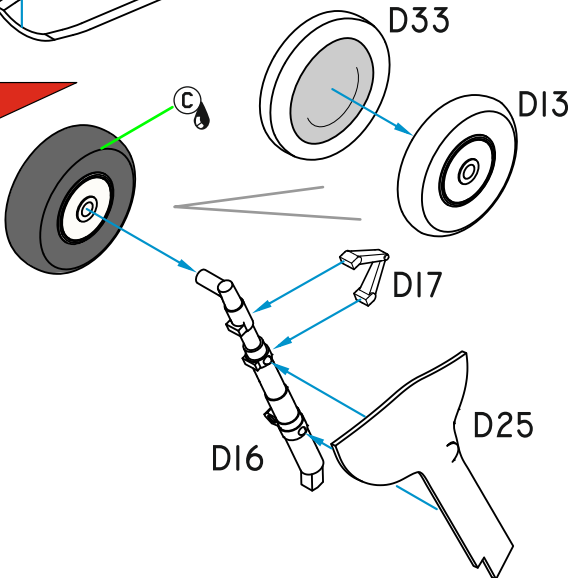

8

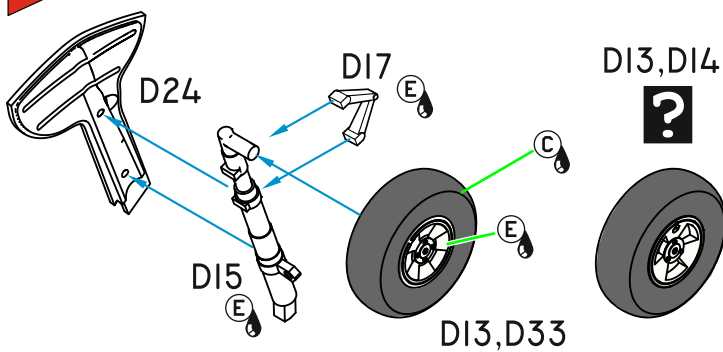

9

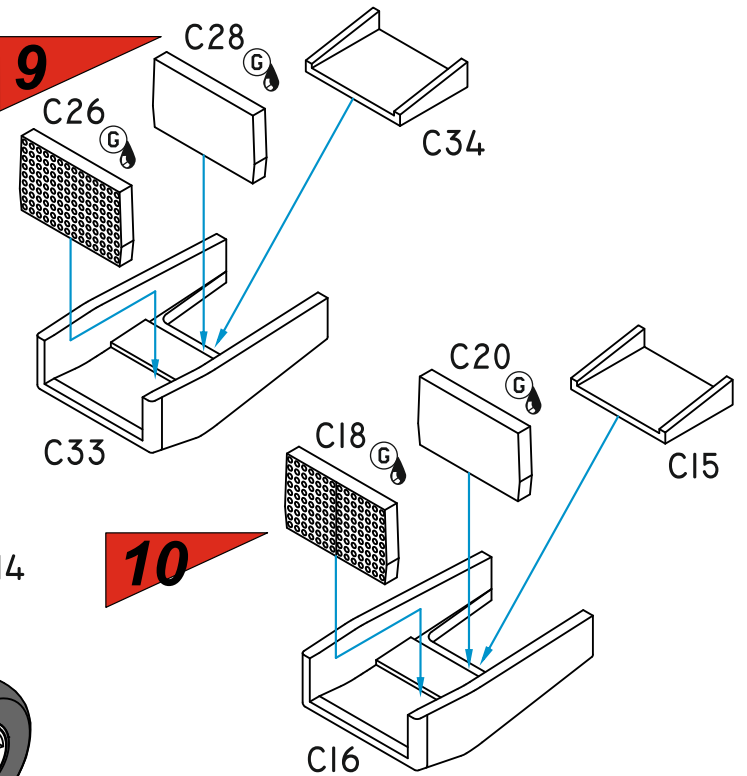

10

6

SESTAVA - ASSEMBLY - BAUANLEITUNG - ASSEMBLAGE

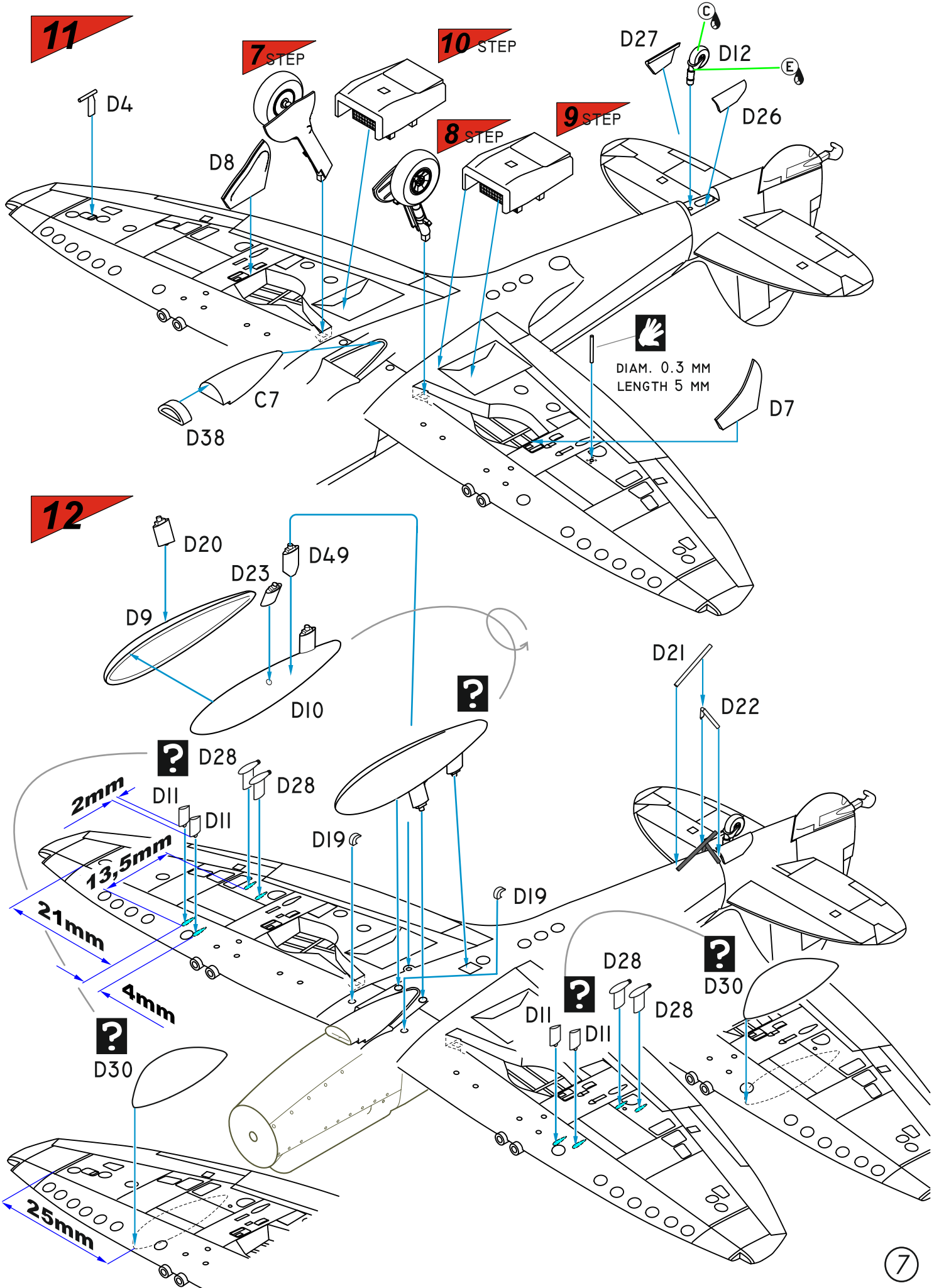

13

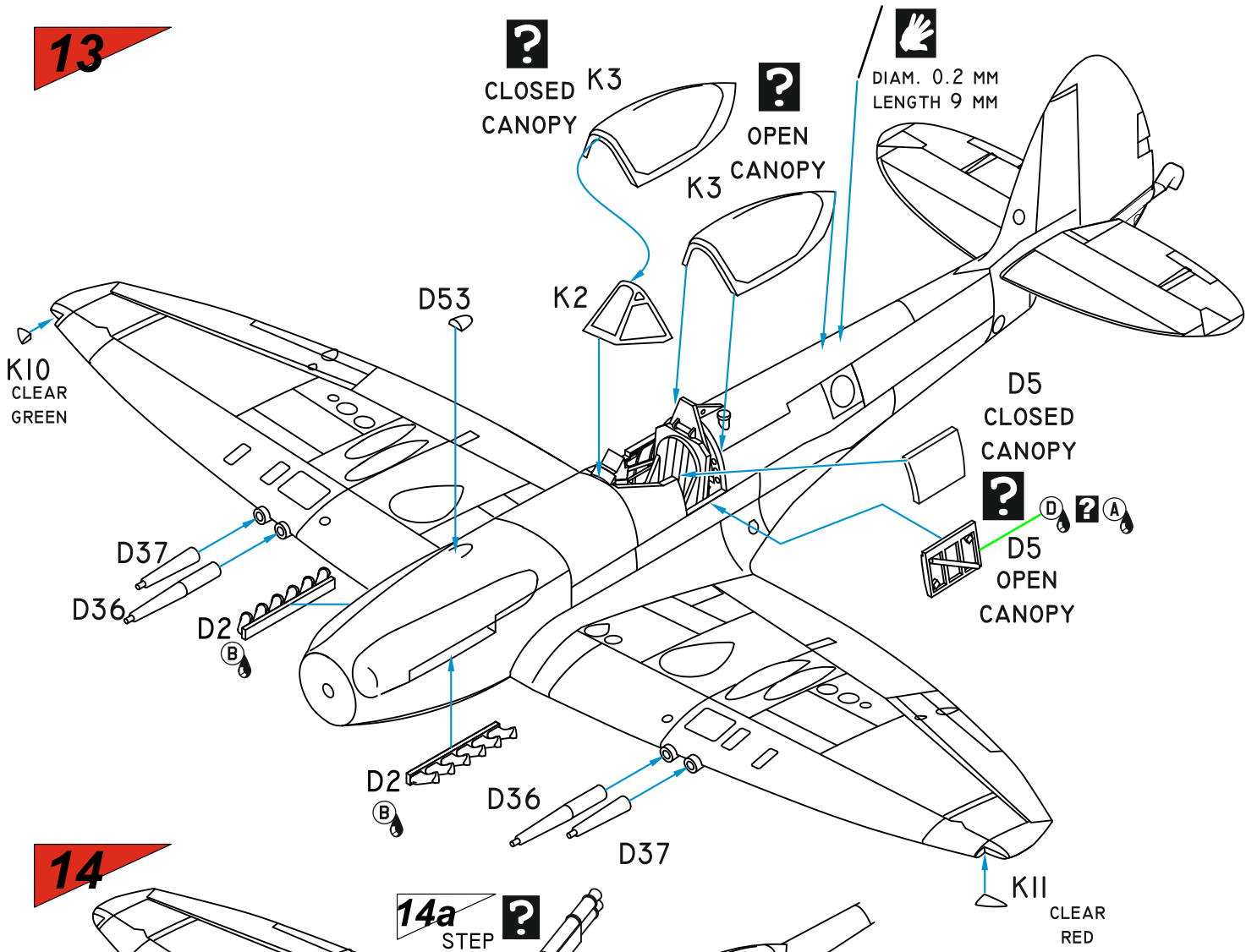

14

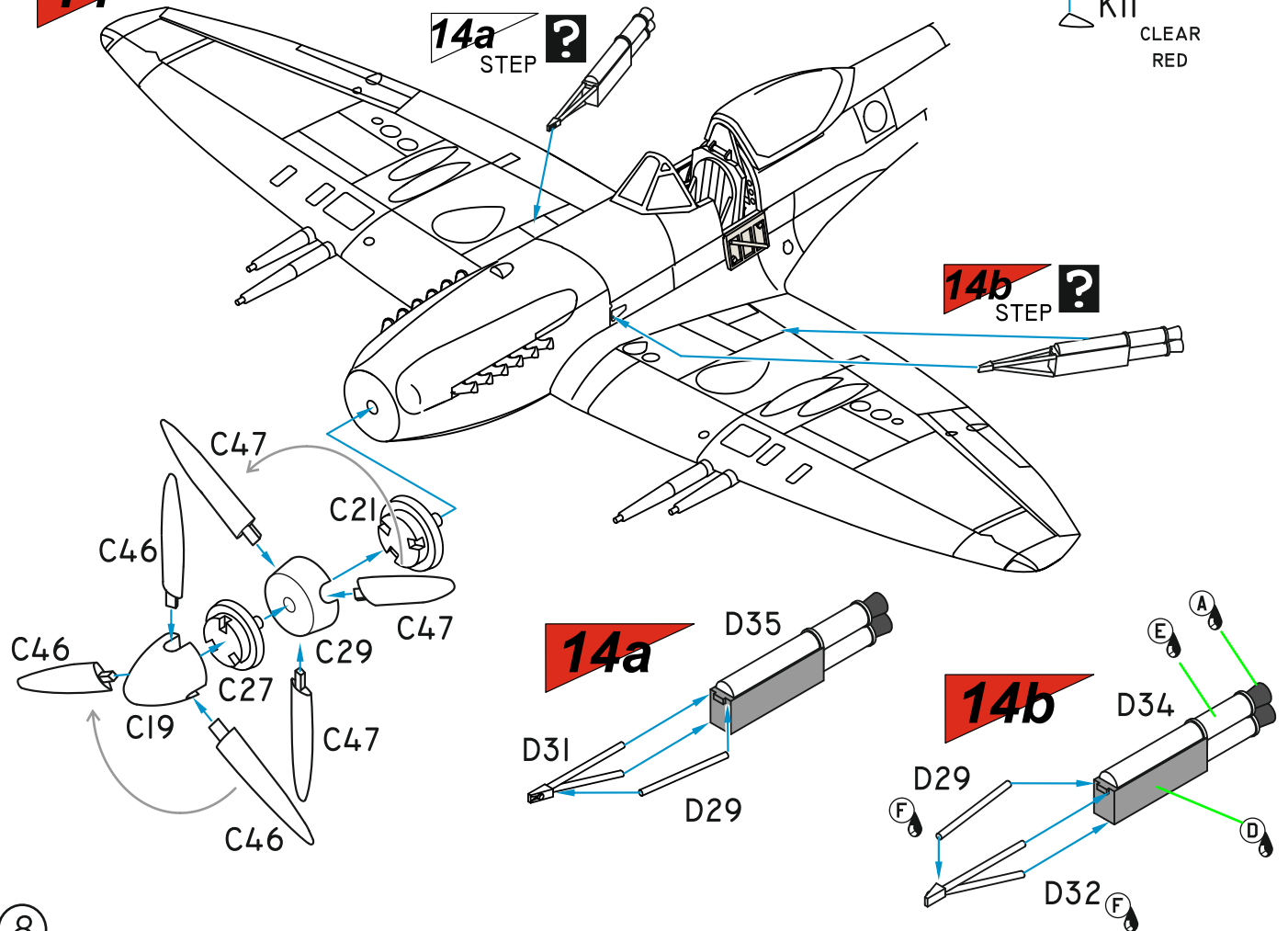

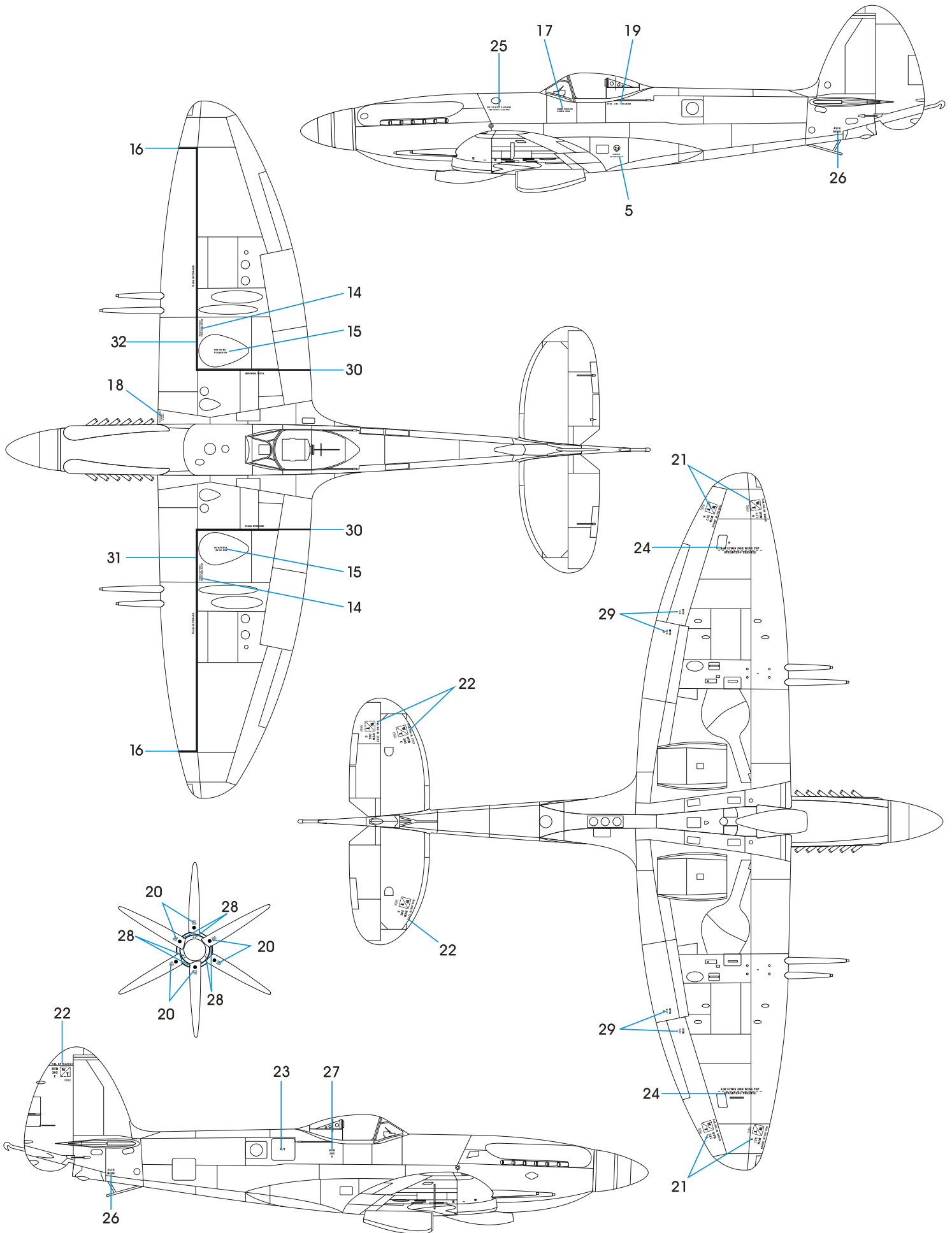

Seafire FR Mk.46, LA561/104-CH, No.1832 Sqn. FAA, RNAS Culham, květen 1948. Kamufláž tohoto Seafiru se na horních plochách skládala z polí barev Extra Dark Sea Grey a Dark Slate Grey, na spodní plochy byla použita barva Sky. Kužel vrtule byl natřený žlutou barvou a přídatná nádrž pravděpodobně barvou Dark Slate Grey. Barvy byly lesklé.



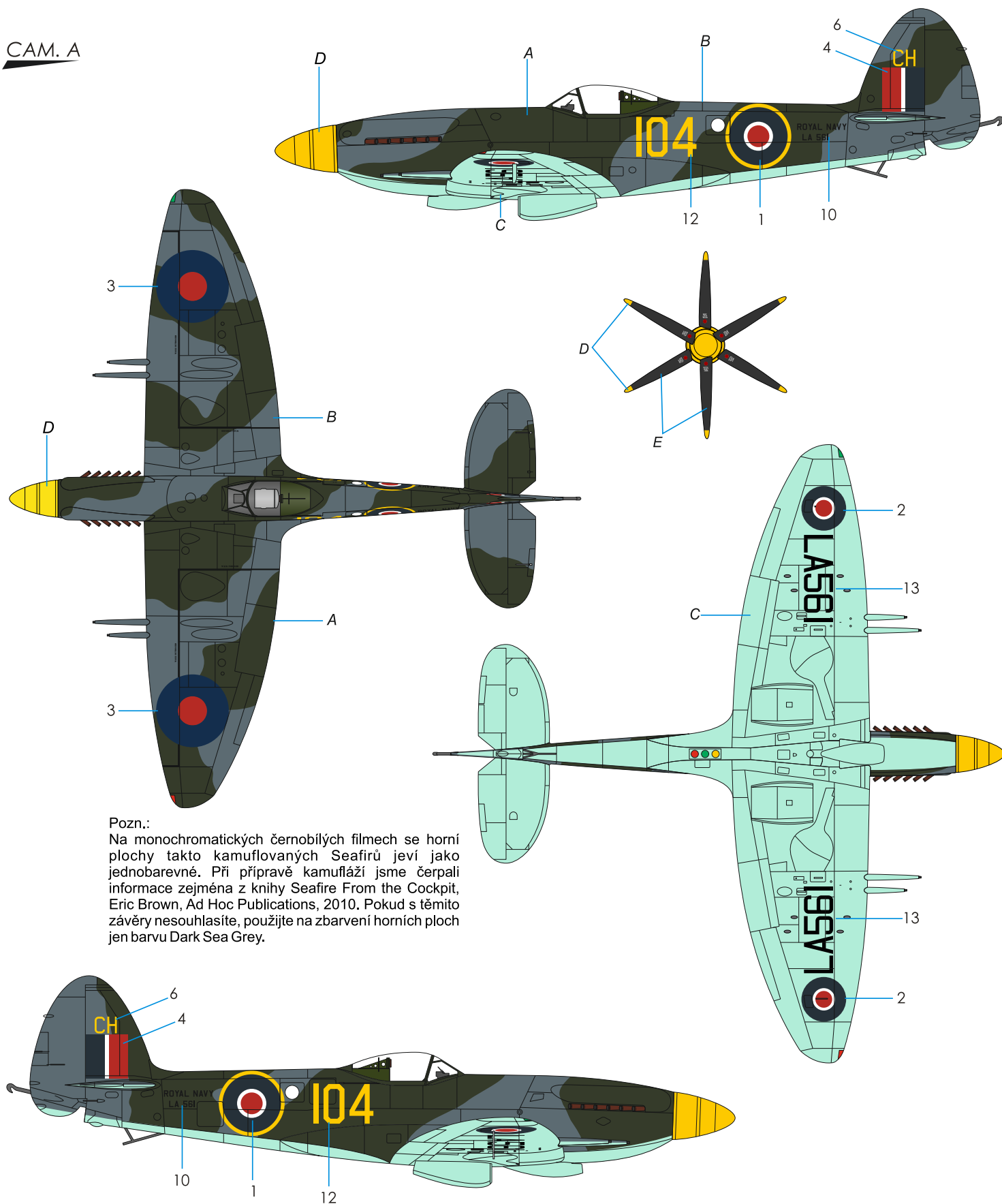

Supermarine Seafire FR Mk.46, LA561/104-CH, , FAA No.1832 Squadron, RNAS Culham, May 1948. The camouflage scheme of this Seafire consisted of Extra Dark Sea Grey and Dark Slate Grey areas on upper surfaces with Sky on lower ones. The spinner was yellow and external tank probably Dark Slate Grey. All colors were glossy.

CAM. A



Pozn.:

Na monochromatických černobílých filmech se horní plochy takto kamuflovaných Seafirů jeví jako jednobarevné. Při přípravě kamufláže jsme čerpali informace zejména z knihy Seafire From the Cockpit, Eric Brown, Ad Hoc Publications, 2010. Pokud s těmito závěry nesouhlasíte, použijte na zbarvení horních ploch jen barvu Dark Sea Grey.

- | | | | | |
|---|--|---|--|--|
| <p>A</p>  <p>Tmavá břidlicová šedá
Dark Slate Grey
H78/C38 50%
H32/C40 50%</p> | <p>B</p>  <p>Extra tmavá mořská šedá
Extra Dark Sea Grey
H333/C333</p> | <p>C</p>  <p>Nebeská modrá
Sky
C368</p> | <p>D</p>  <p>Žlutá
Yellow
H329/ C329</p> | <p>E</p>  <p>Matná Černá
Flat Black
H12/ C33</p> |
|---|--|---|--|--|

Supermarine Seafire F Mk.46, LA545/110-CH, No.1832 Sq. FAA, RNAS Culham, květen 1948. Kamufláž tohoto Seafiru se na horních plochách skládala z polí barev Extra Dark Sea Grey a Dark Slate Grey, na spodní plochy byla použita barva Sky. Kužel vrtule byl natřený žlutou barvou a přídavná nádrž pravděpodobně Dark Slate Grey. Barvy byly lesklé.

Supermarine Seafire F Mk.46, LA545/110-CH, FAA No.1832 Sq., RNAS Culham, May 1948. The camouflage scheme of this Seafire consisted of Extra Dark Sea Grey and Dark Slate Grey areas on upper surfaces with Sky on lower ones. The spinner was yellow and external tank probably Dark Slate Grey. All colors were glossy.

CAM. B

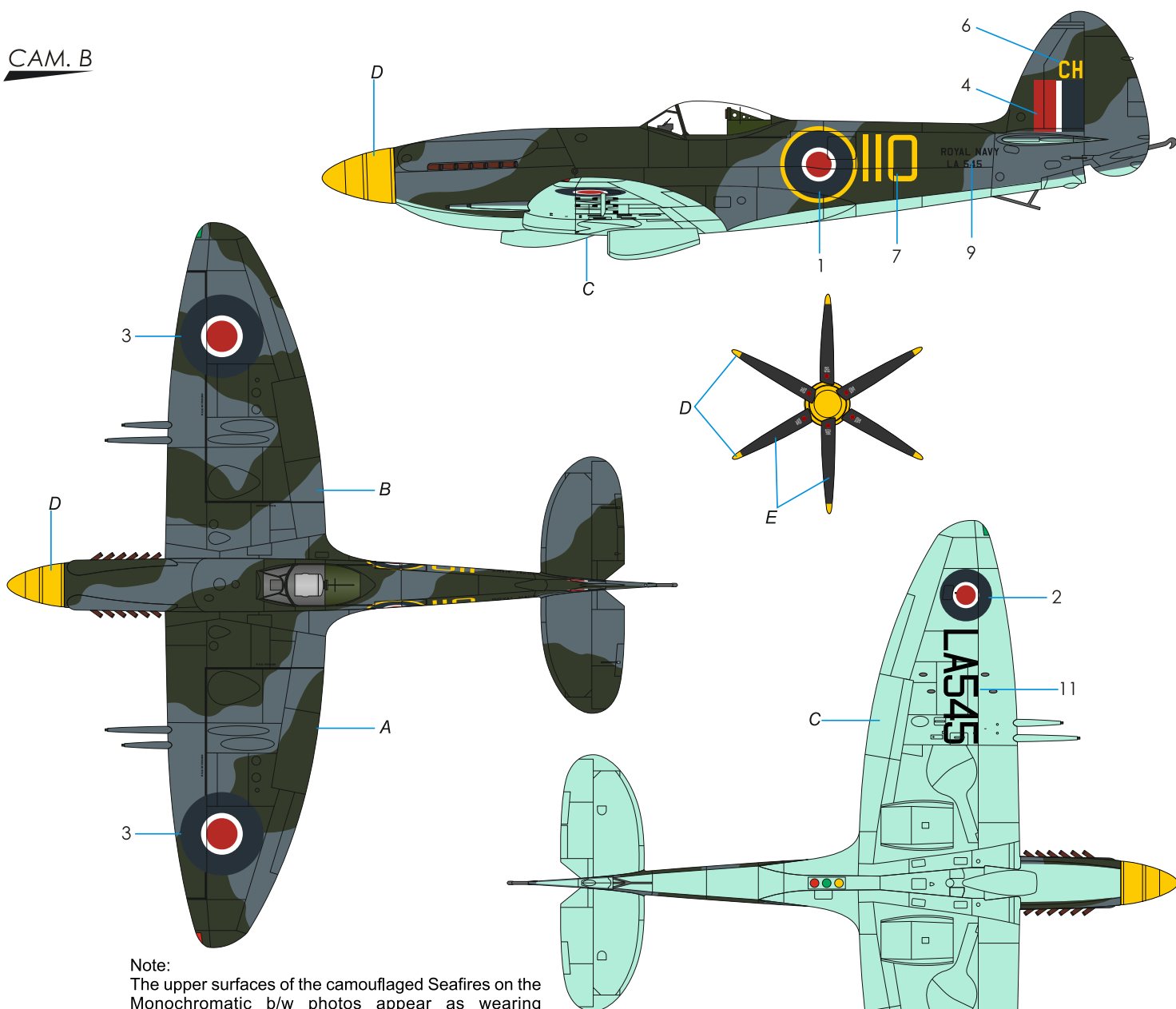

Note:
The upper surfaces of the camouflaged Seafires on the Monochromatic b/w photos appear as wearing homogenous one color. Our camouflage schemes were prepared using mainly references from Seafire From The Cockpit by Eric Brown, Ad Hoc Publications, 2010. If you do not agree with the conclusion use only Dark Sea Grey for upper surface camouflage.

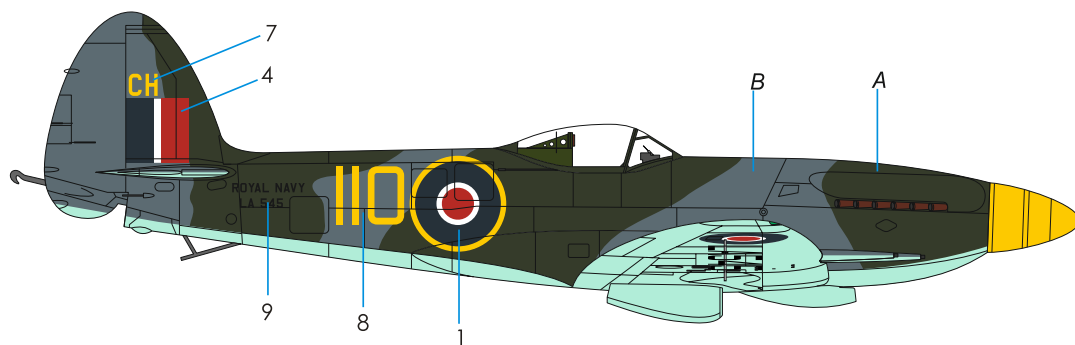

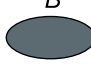
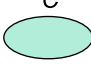
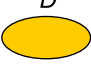
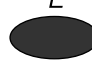
- | | | | | |
|---|--|---|--|--|
| <p>A</p>  <p>Tmavá břidlicová šedá
Dark Slate Grey
H78/C38 50%
H32/C40 50%</p> | <p>B</p>  <p>Extra tmavá mořská šedá
Extra Dark Sea Grey
H333/C333</p> | <p>C</p>  <p>Nebeská modrá
Sky
C368</p> | <p>D</p>  <p>Žlutá
Yellow
H329/ C329</p> | <p>E</p>  <p>Matná Černá
Flat Black
H12/ C33</p> |
|---|--|---|--|--|

1/72 SH72368



Fairey Fulmar Mk.II/NF Mk.II

1/72 SH72408



Fairey Barracuda Mk.III 'ASV Mk.XI Radar'

1/72 SH72408



Short Sunderland Mk.I/II 'The Flying Porcupine'